

Stairway 700/1000

Temporary access solutions for construction sites
according to EN 12811

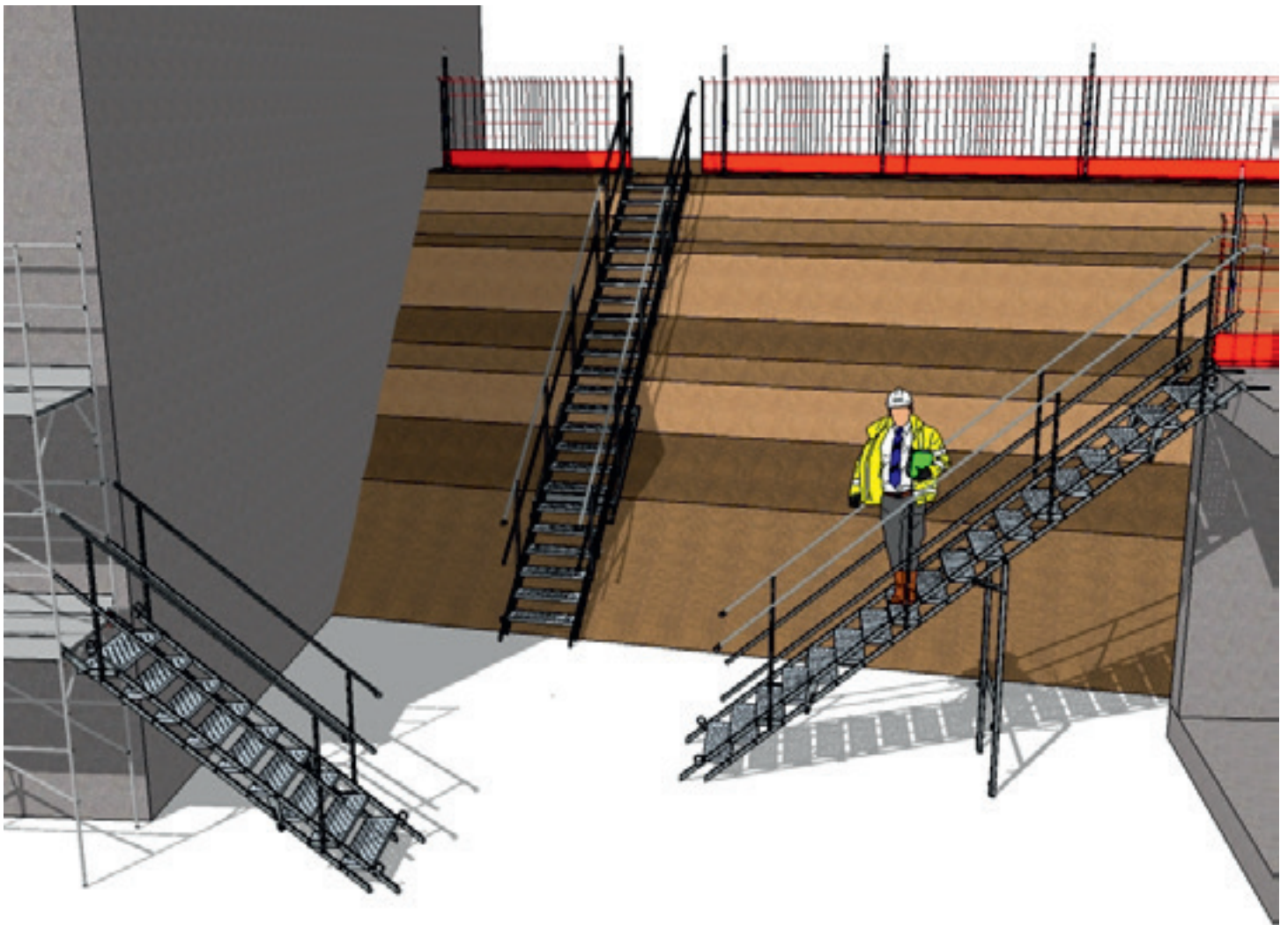

Inhaltsverzeichnis

Inclination Diagram.	3
Stairway Assembly.	4
Slabfix for Stairway.	5
Scaffoldfix for Stairway	6
Stairway Support Assembly.	7
Stairway 700 and 1000	8
3-step Stairway.	9
6-step Stairway.	10
9-step Stairway.	11
12-step Stairway.	12
15-step Stairway.	13
18-step Stairway.	14
Connection of two Stairways.	15
Connection of two Handrails.	16
Order of two connected Stairways	17
Stairway Components.	29
Description of Stairway Components.	30
Illustration of Stairway Components.	31
Needed Screws and Nuts.	33
Sticker for Stairways.	34

Inclination Diagram

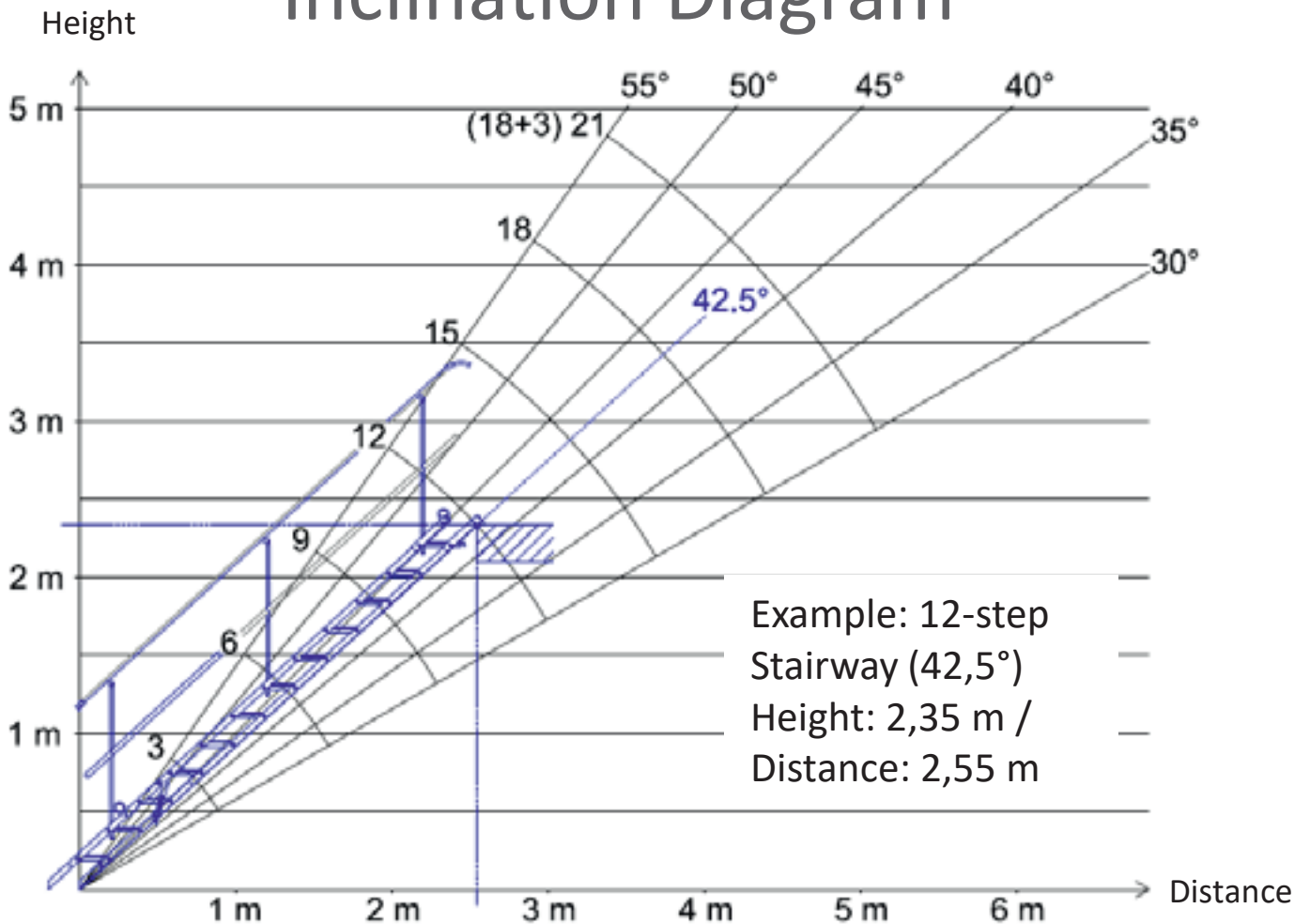

Connection of two Stairways (self-supporting)	3 steps	6 steps	9 steps	12 steps	15 steps	18 steps
3 steps	✓	✓	✓	●	✓	✓
6 steps	✓	✓	●	●	✓	✗
9 steps	✓	●	●	●	✗	✗
12 steps	●	●	●	✗	✗	✗
15 steps	✓	✓	✗	✗	✗	✗
18 steps	✓	✗	✗	✗	✗	✗

✓ yes

✗ no

● Support needed

Stairway Assembly

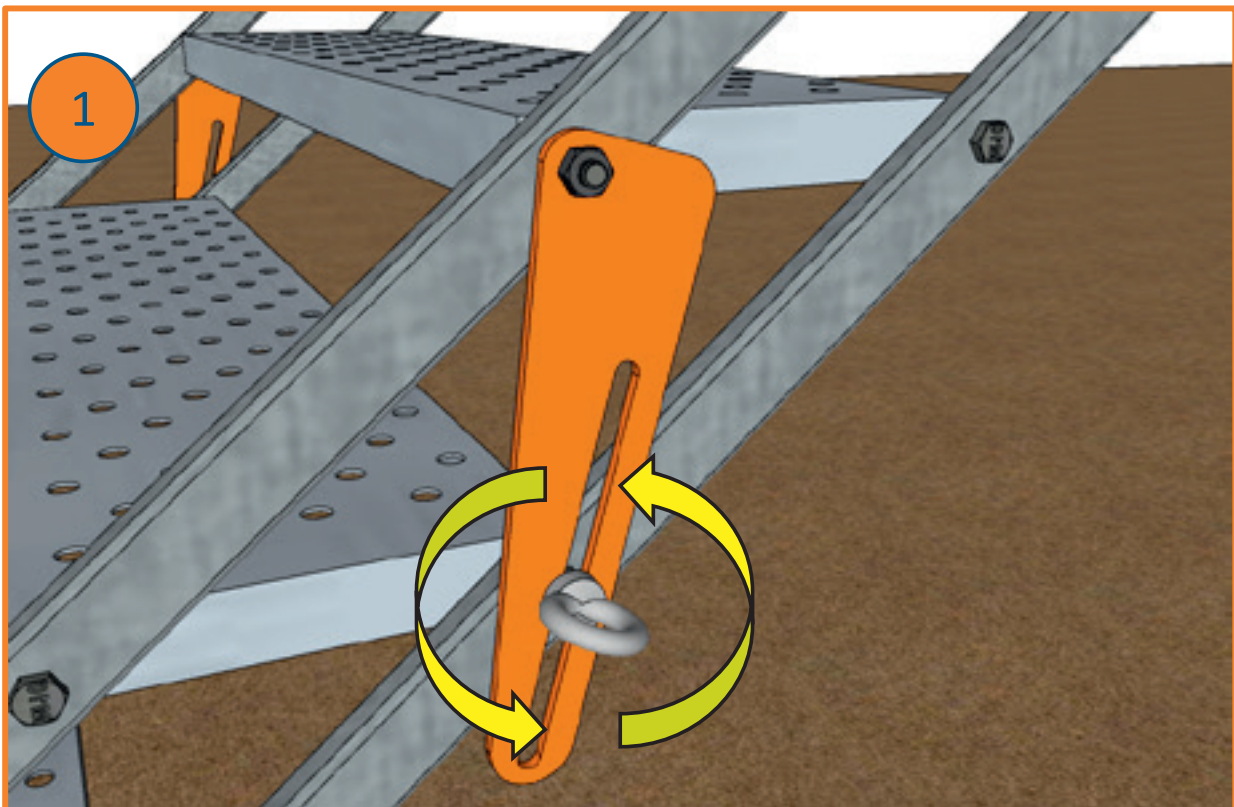

Loose all the locks so that the stairways can be unfolded at the edge of the slab.

The bolts of the step do not have to be released.



Stairway 3-, 6-, 9-steps two locks (one on each side)



Stairway 12-, 15-, 18-steps four locks (two on each side)

Stairway Assembly

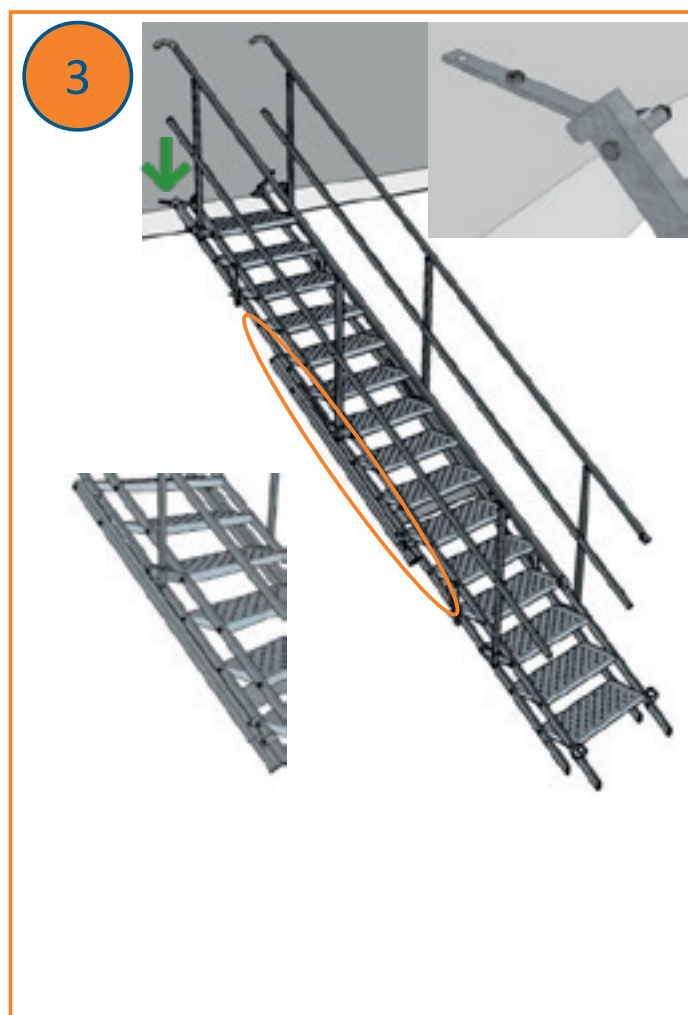
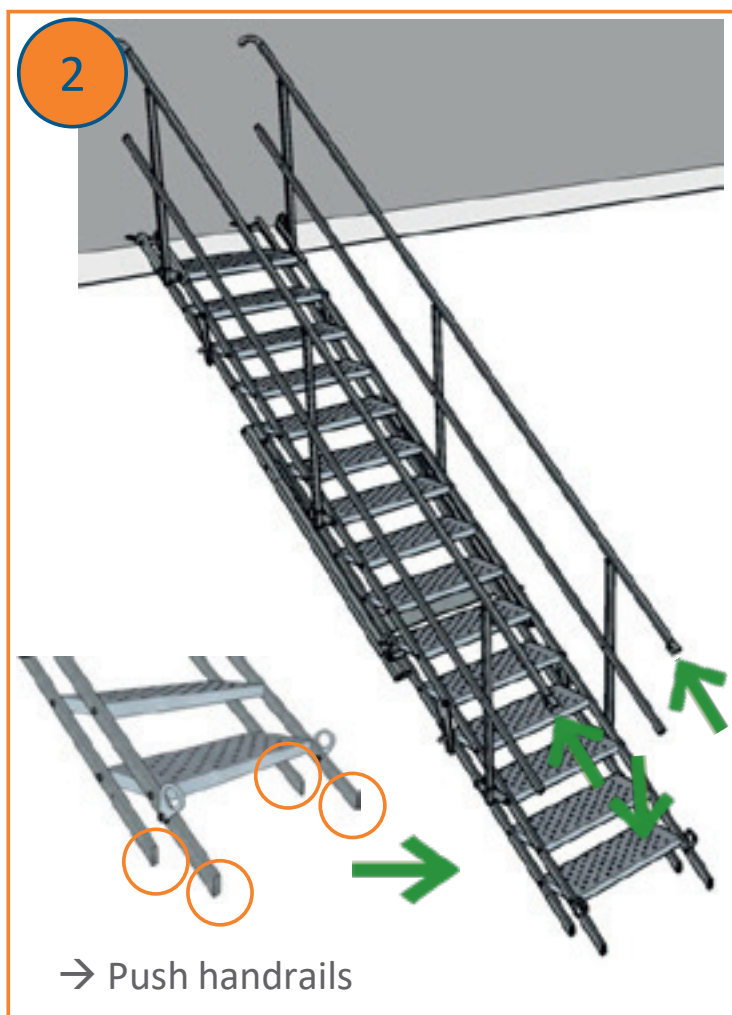
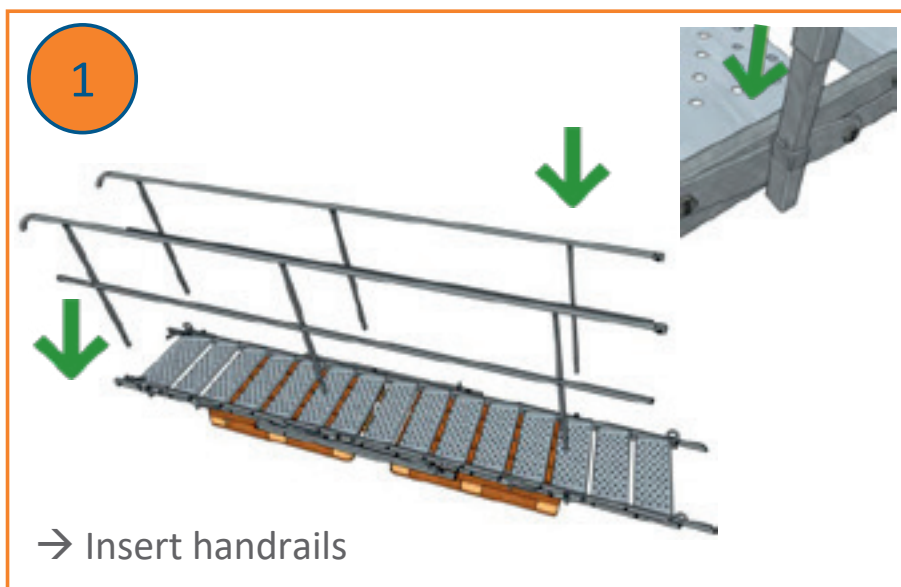

Slabfix for Stairway

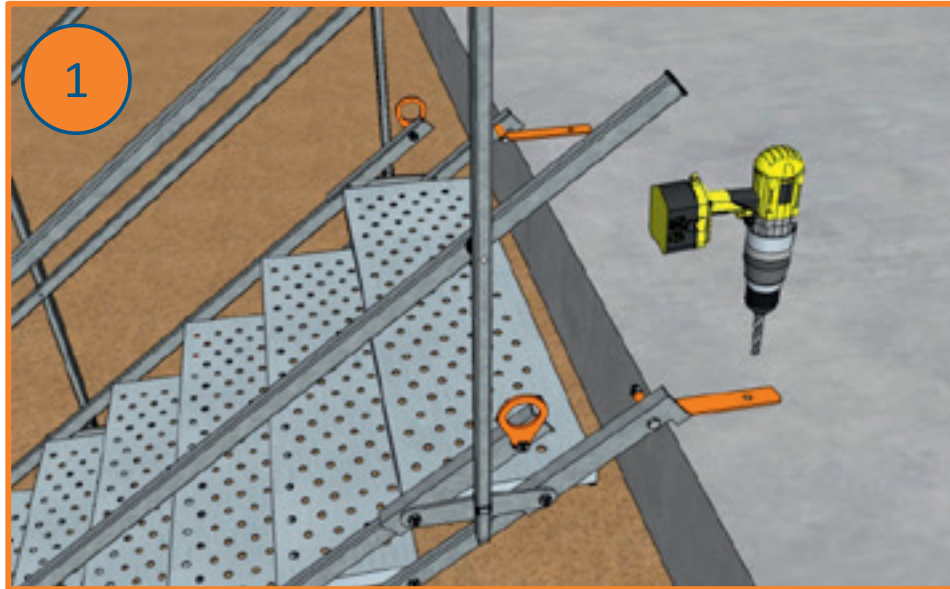

Fastening of the Slabfix with heavy-duty anchor

For example Hilti heavy-duty anchor HSL-3 M12/5 or similar

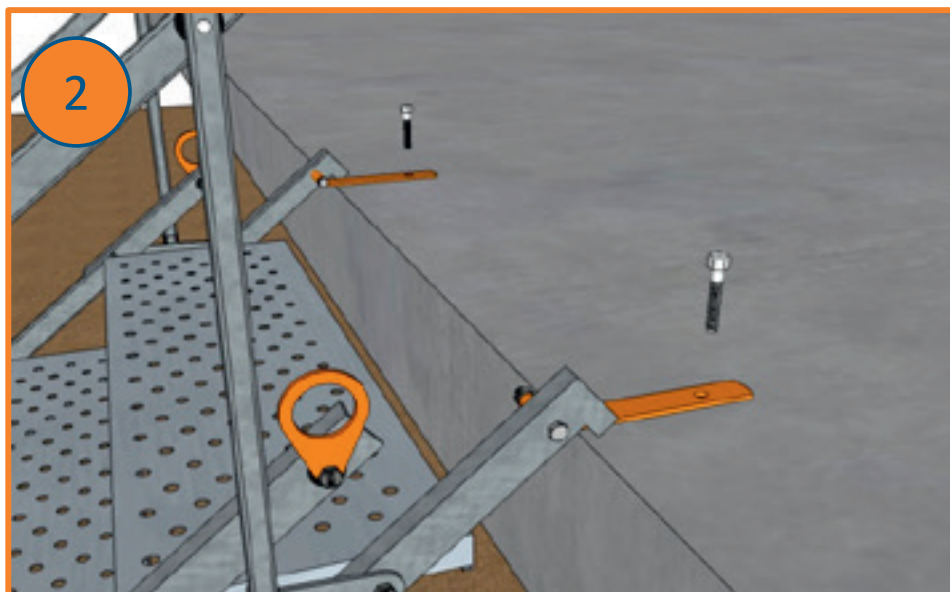

Scaffoldfix for Stairway

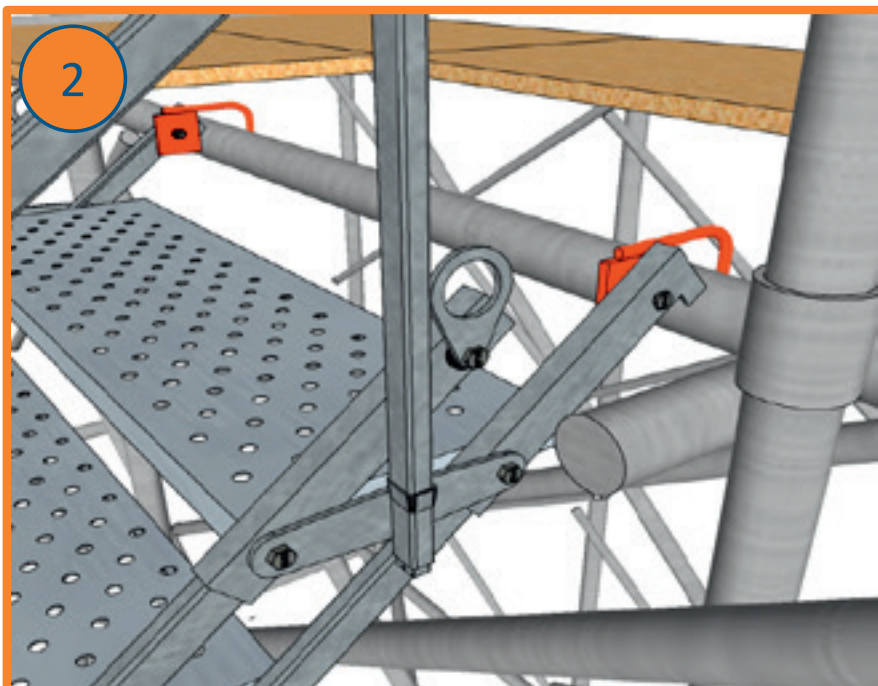
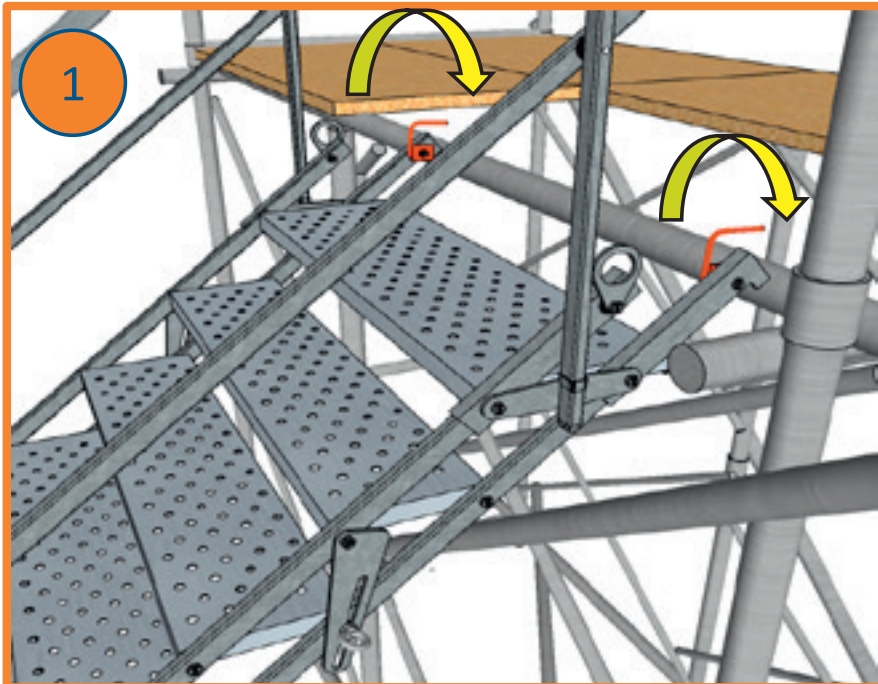

Stairway Support Assembly

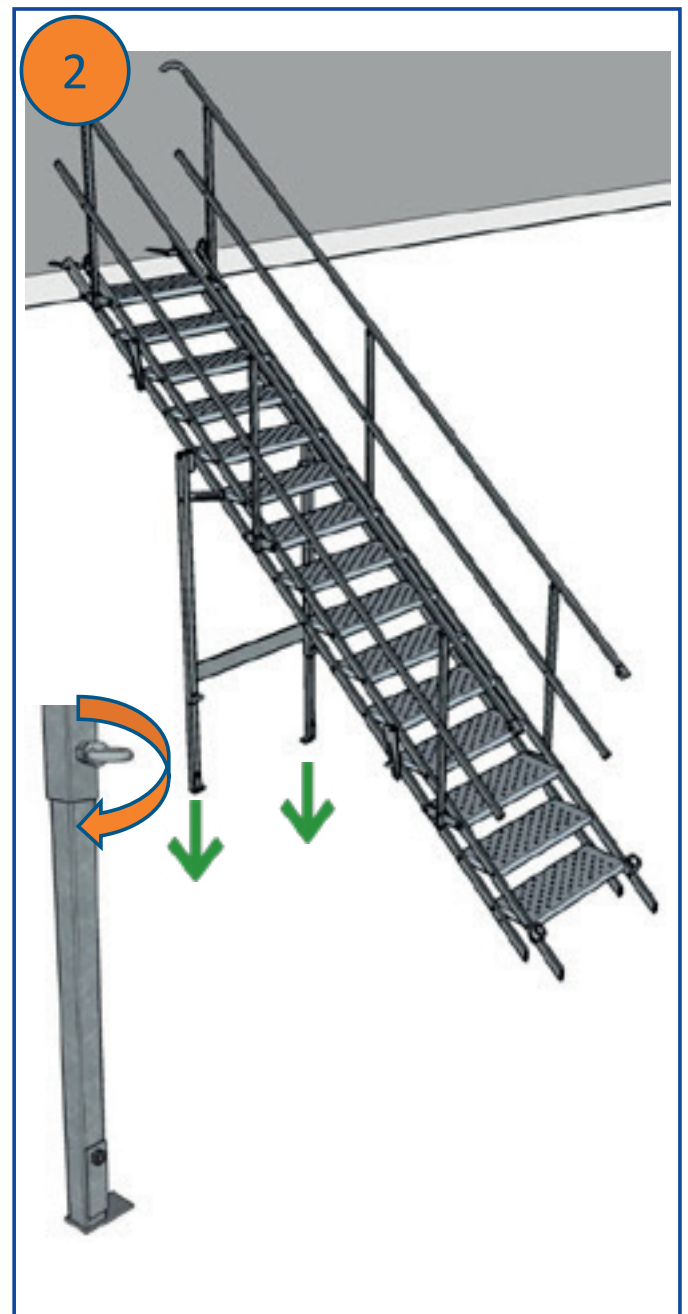
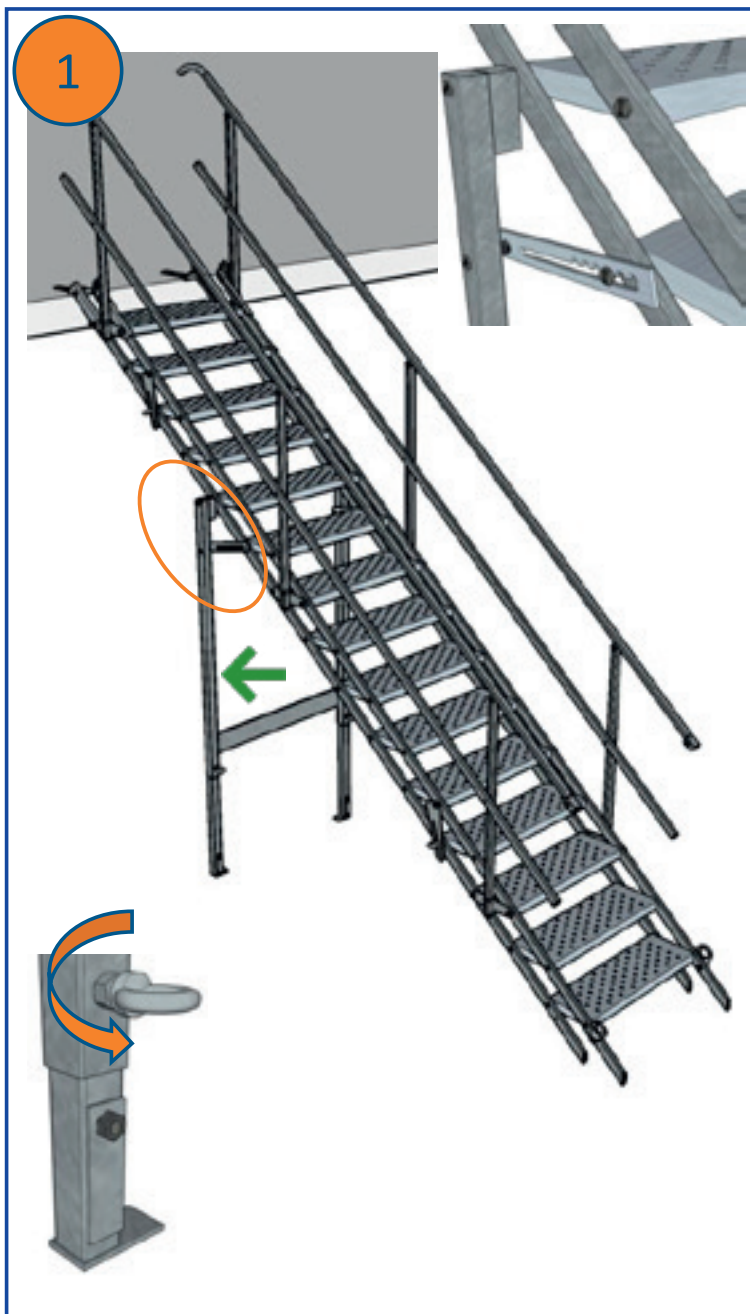

Stairway 700 and 1000



Inner width:
approx. 700 mm



Inner width:
approx. 1000 mm

3-step Stairway

EN 12811
1,5 kN/m²

Stairway 700 mm:
Item No.: 5060003
40 kg

Stairway 1000 mm:
Item No.: 5061003
45 kg



Max. 10 pcs

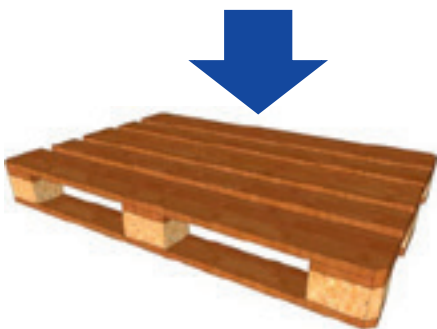

Stairway 700 mm: 420 kg
Stairway 1000 mm: 470 kg

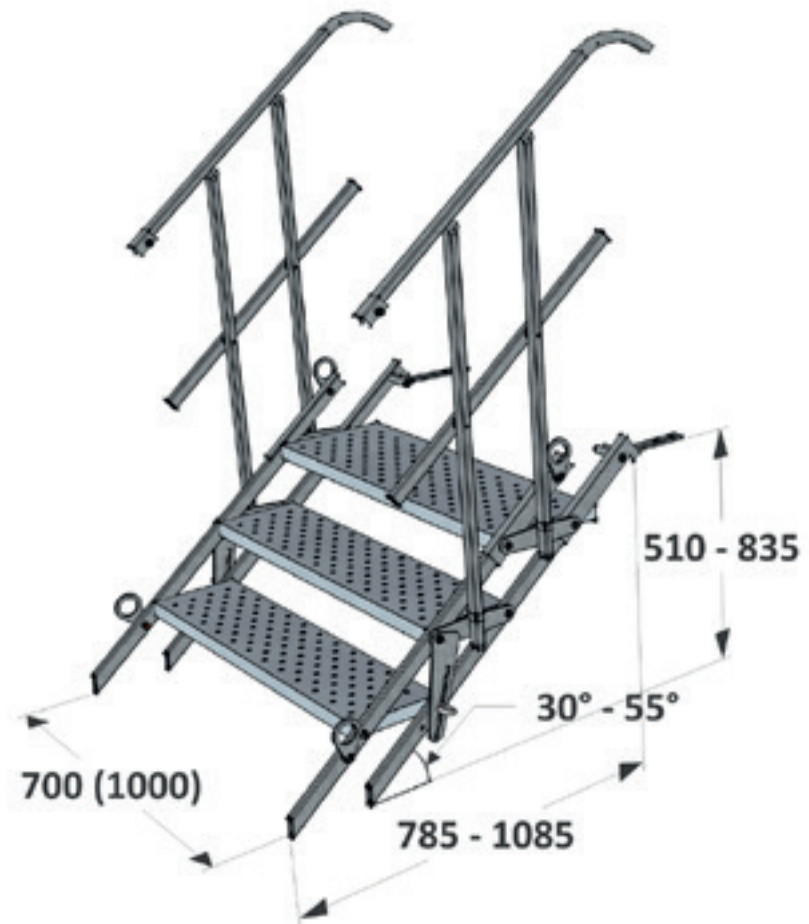

Max. 2
persons

[mm]

6-step Stairway

EN 12811
1,5 kN/m²

Stairway 700 mm:
Item No.: 5060006
63 kg

Stairway 1000 mm:
Item No.: 5061006
73 kg



Max. 10 pcs

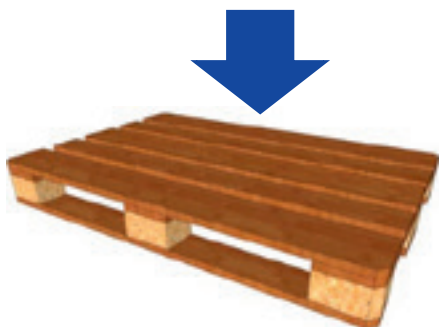

Stairway 700 mm: 650 kg
Stairway 1000 mm: 750 kg



Max. 2
persons

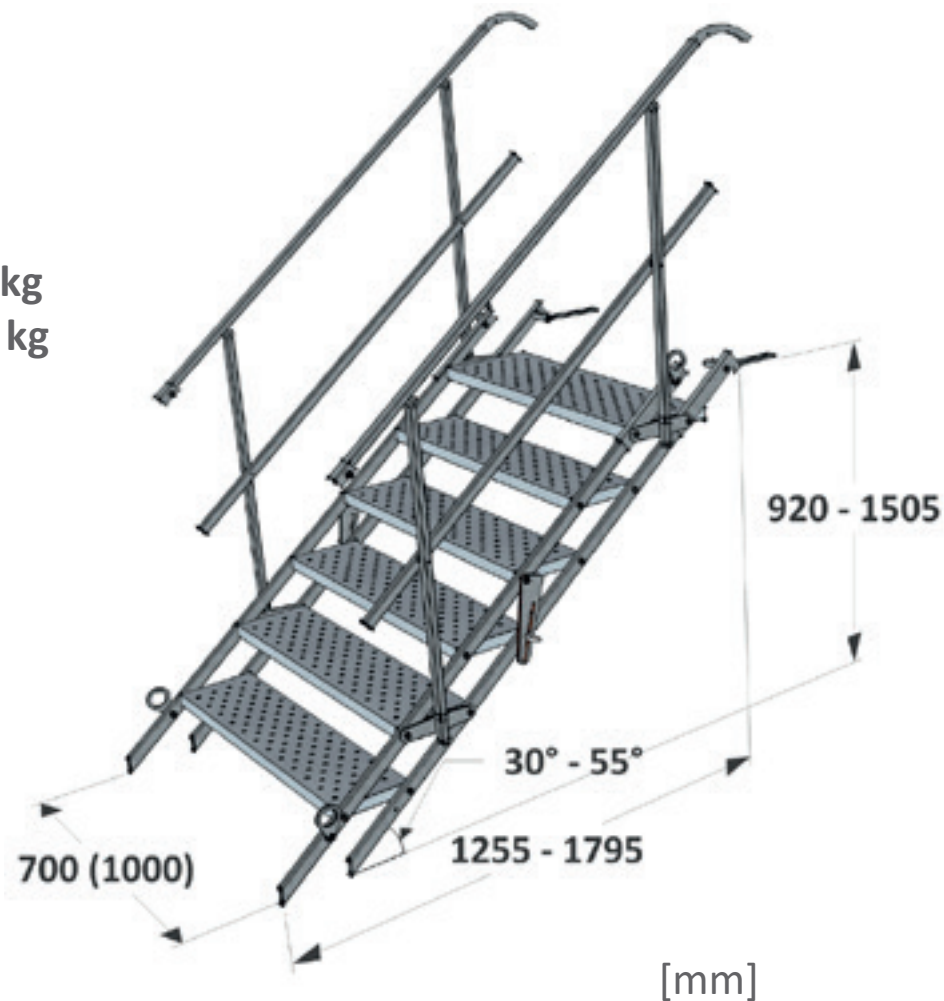

9-step Stairway

EN 12811
1,5 kN/m²

Stairway 700 mm:
Item No.: 5060009
85 kg

Stairway 1000 mm:
Item No.: 5061009
99 kg



Max. 10 pcs

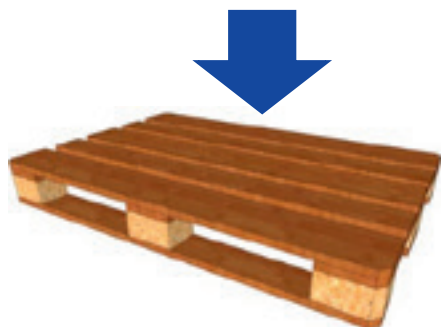

Stairway 700 mm: 870 kg
Stairway 1000 mm: 1010 kg



Max. 2
persons

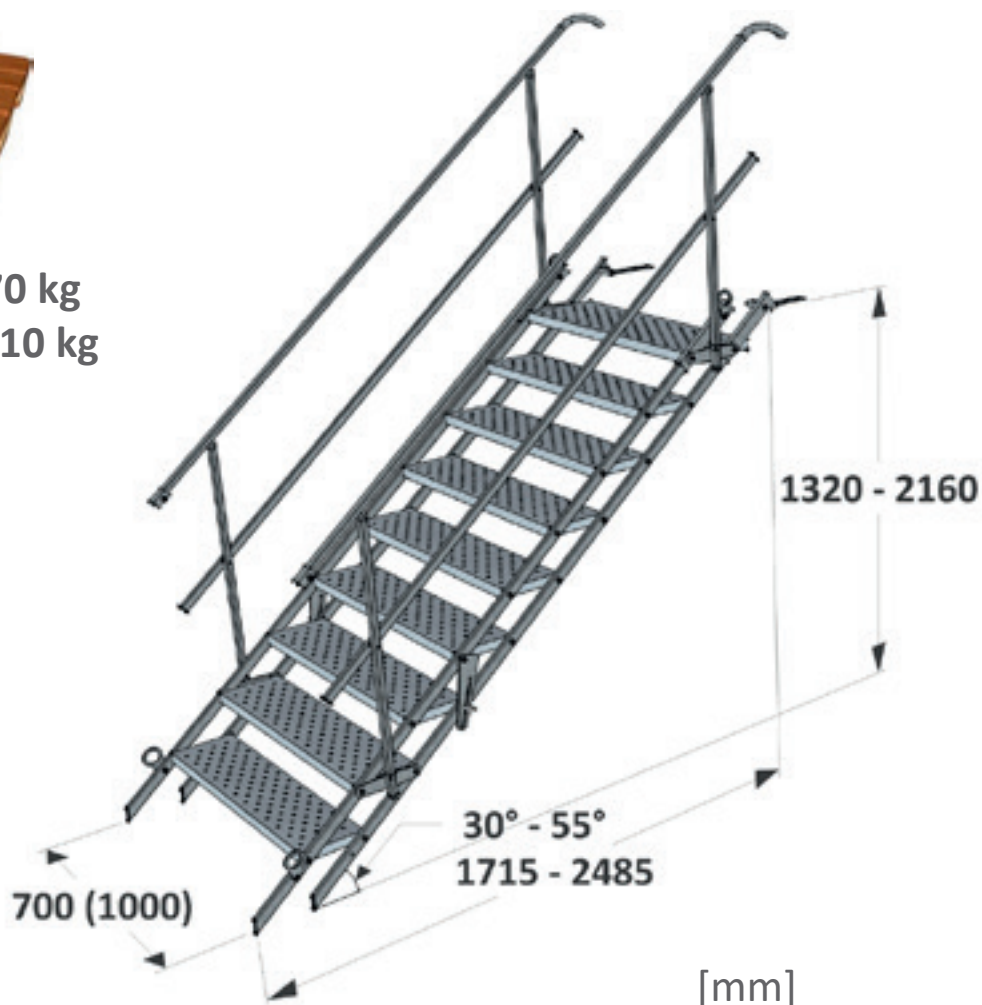

12-step Stairway

EN 12811
1,5 kN/m²

Stairway 700 mm:
Item No.: 5060012
115 kg

Stairway 1000 mm:
Item No.: 5061012
132 kg

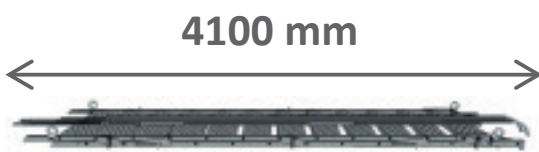

Max. 10 pcs

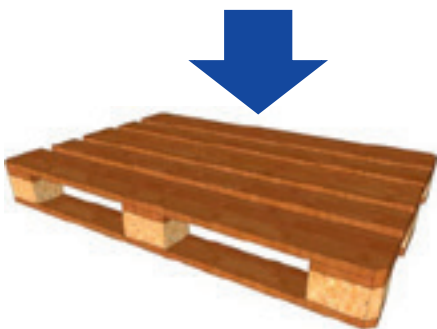

Stairway 700 mm: 1170 kg
Stairway 1000 mm: 1340 kg



Max. 2
persons

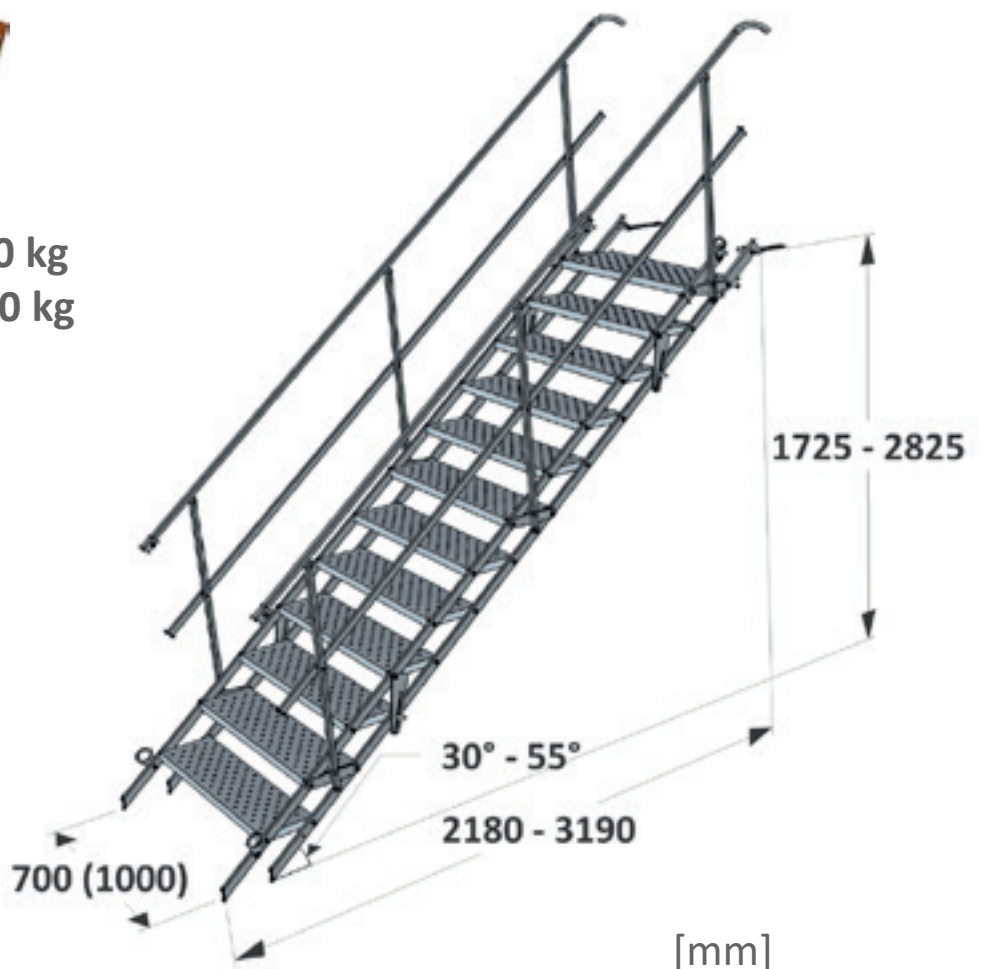

15-step Stairway

EN 12811
1,5 kN/m²

Stairway 700 mm:
Item No.: 5060015
152 kg

Stairway 1000 mm:
Item No.: 5061015
175 kg



Max. 5 pcs



Stairway 700 mm: 800 kg
Stairway 1000 mm: 915 kg



Max. 2
persons

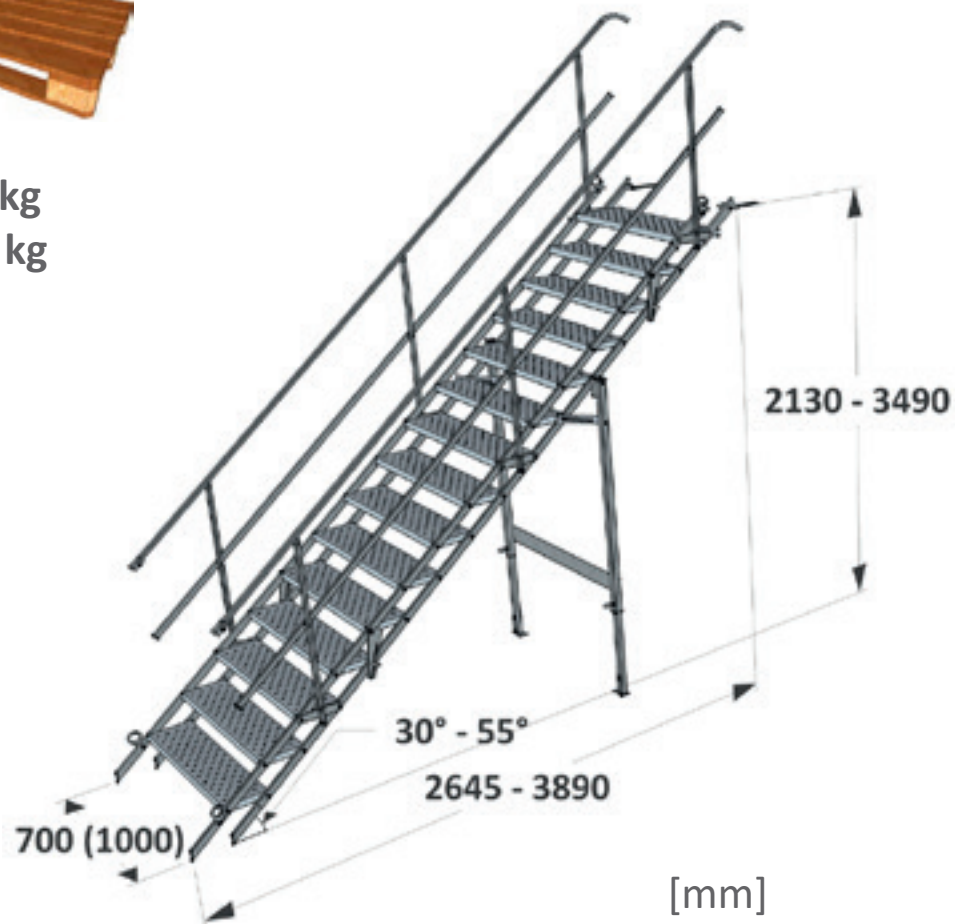

18-step Stairway

EN 12811
1,5 kN/m²

Stairway 700 mm:
Item No.: 5060018
180 kg

Stairway 1000 mm:
Item No.: 5061018
210 kg



Max. 5 pcs



Stairway 700 mm: 940 kg
Stairway 1000 mm: 1090 kg



Max. 2
persons

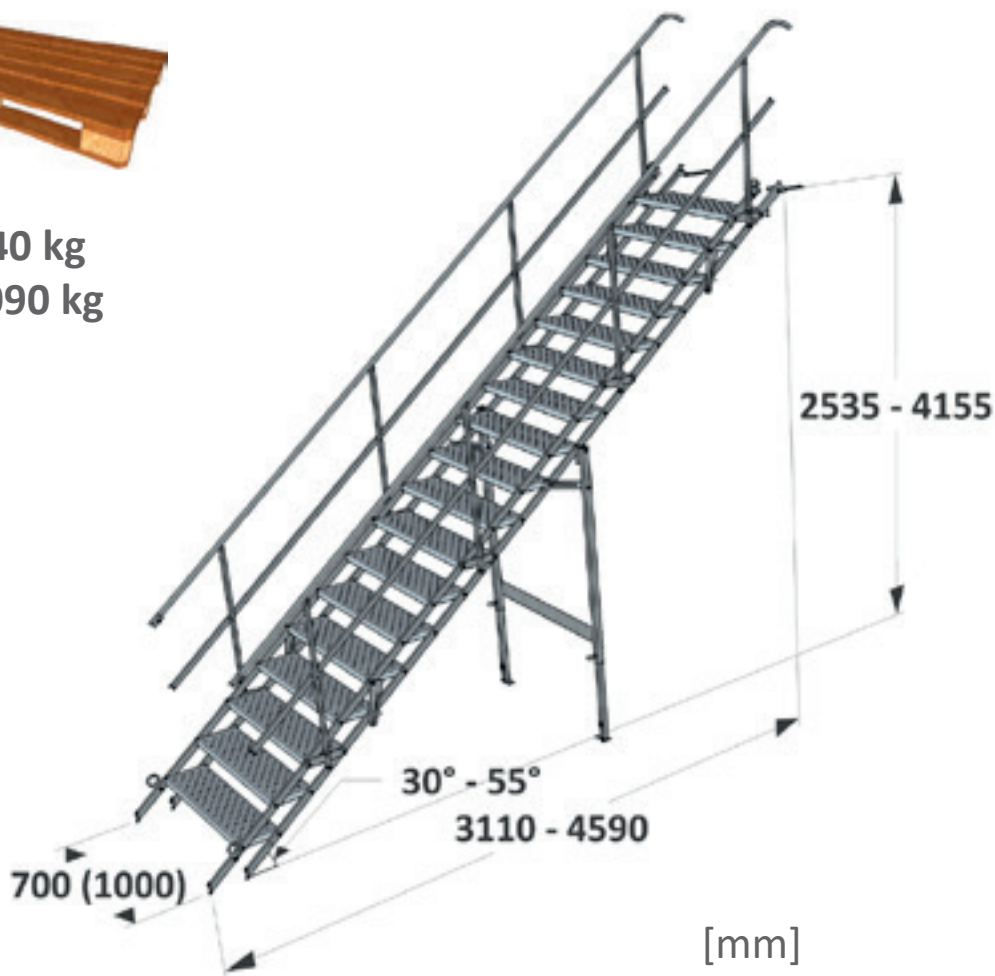

Connection of two Stairways



- max. 2 stairways (self-supporting)
- max. 21 steps (self-supporting)
- 15 – 21 steps only with the stairway support
- > 21 steps without a stairway support, not self-supporting, e.g. on slope subsoil

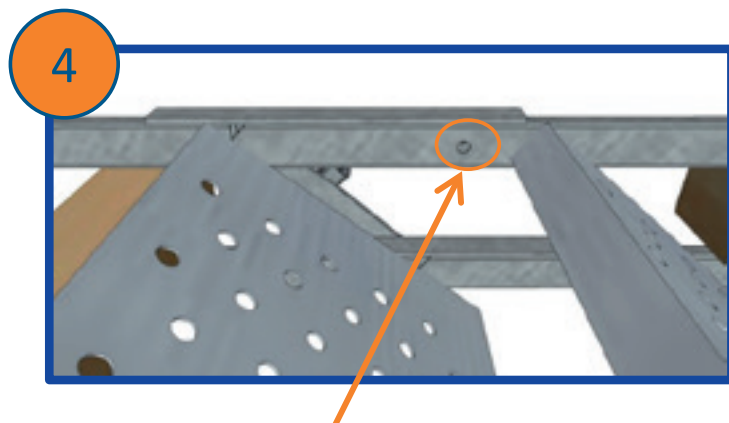
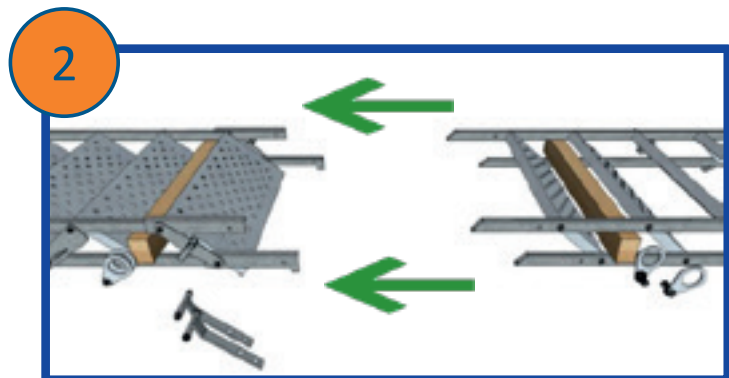
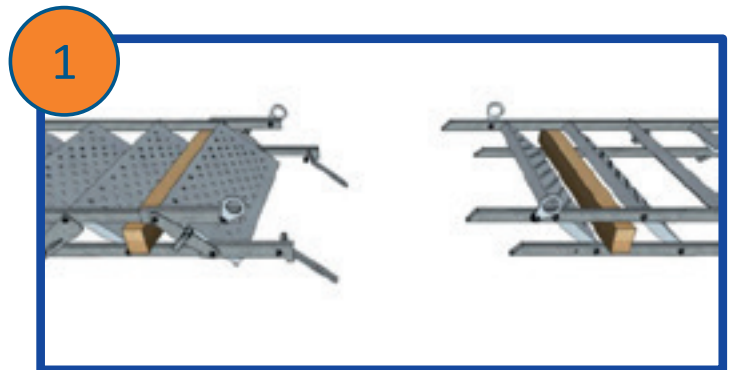

4 times connection with screws

Connection of two Handrails

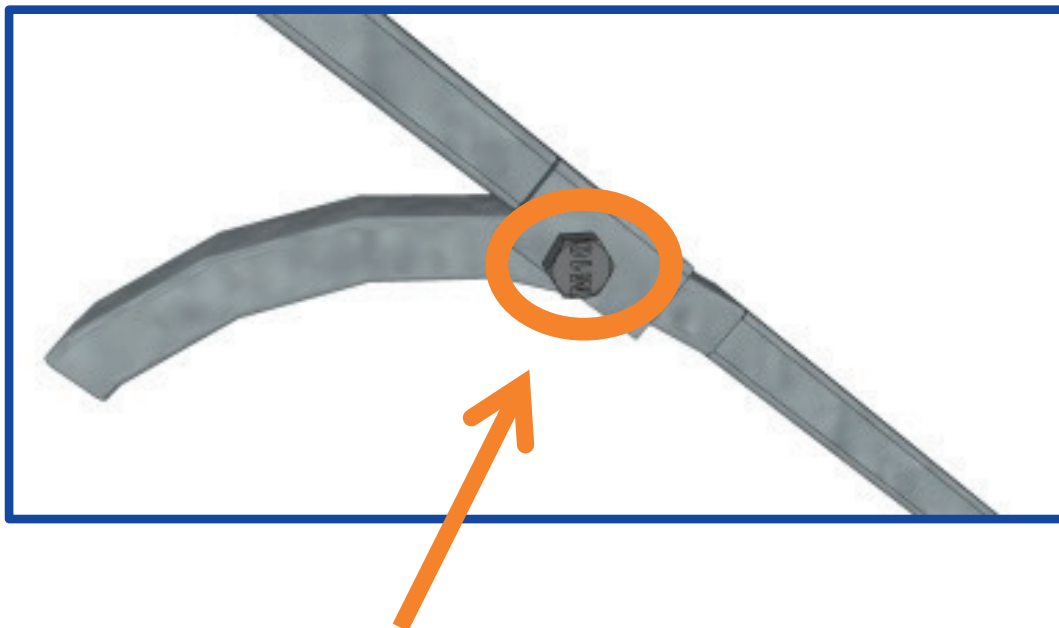
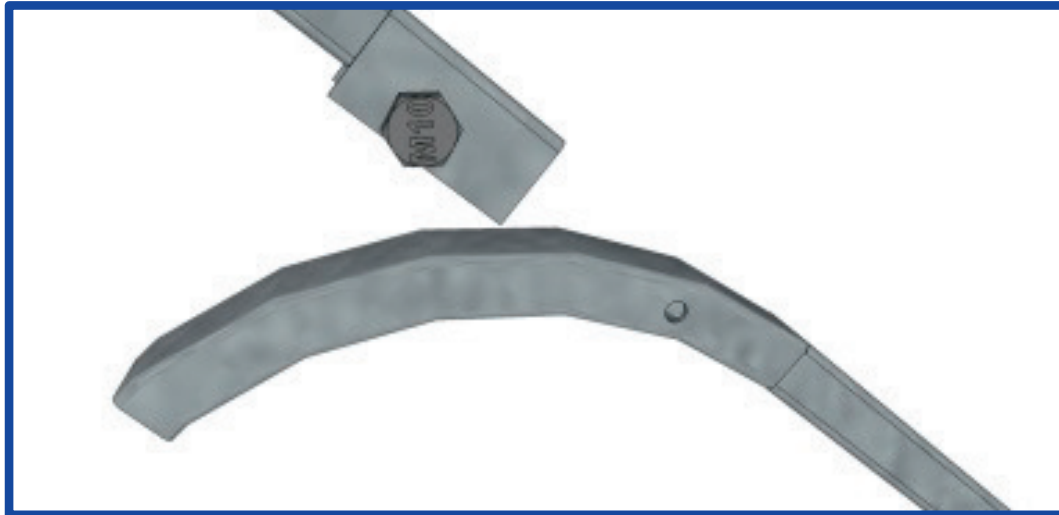

2 times connection with screws

Connection 3-step Stairway with 3-step Stairway

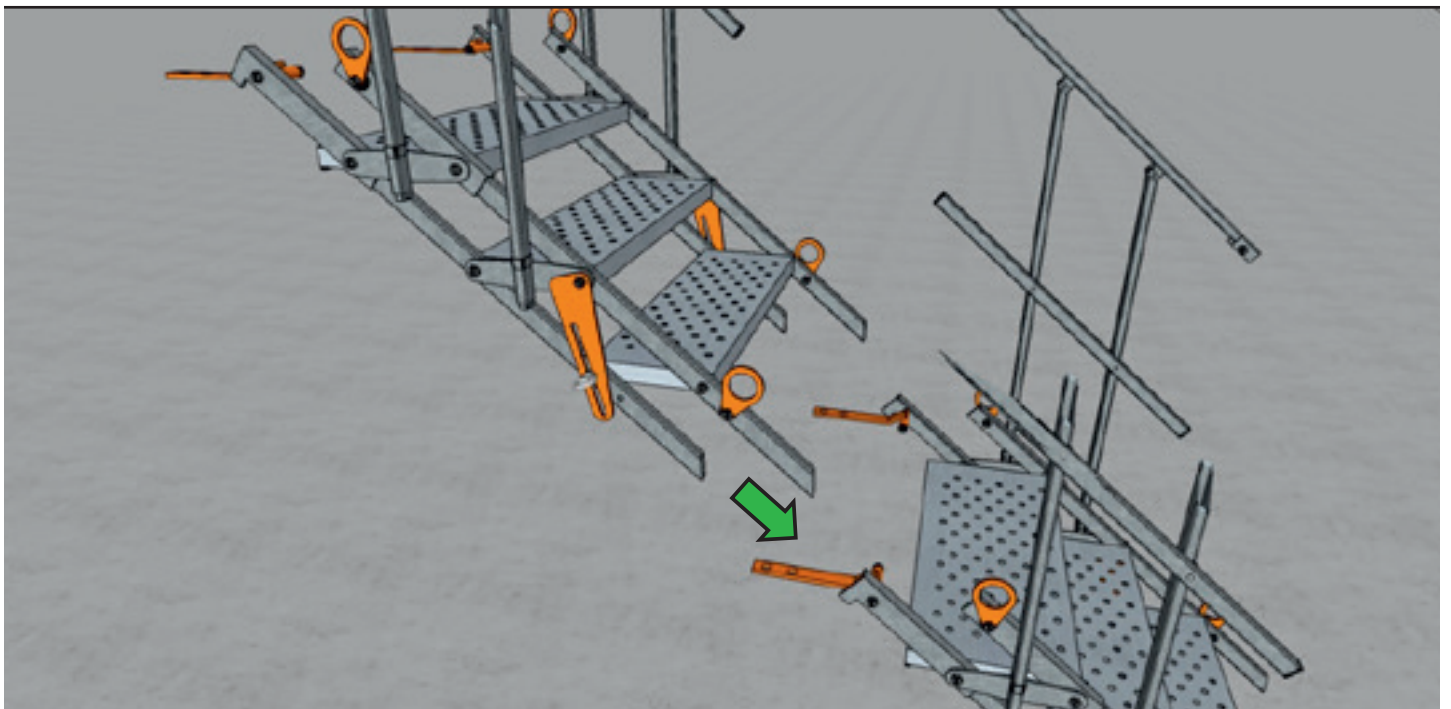
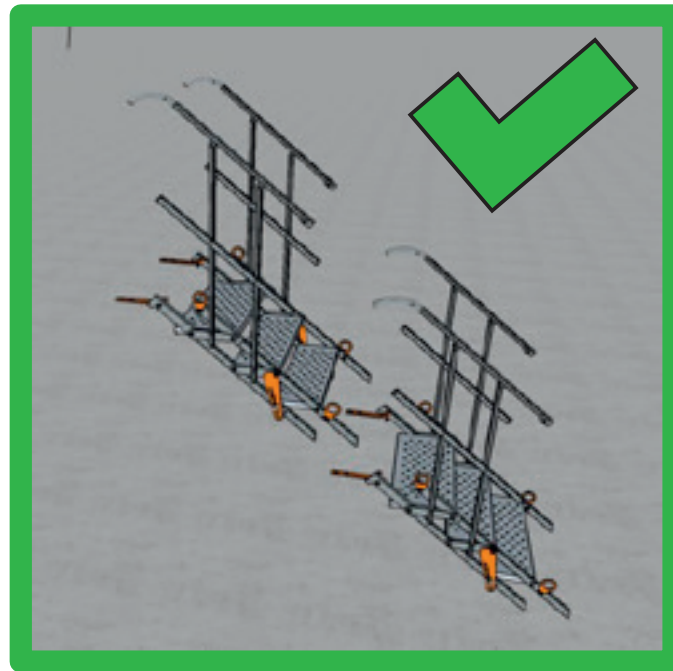

Connection 6-step Stairway with 6-step Stairway

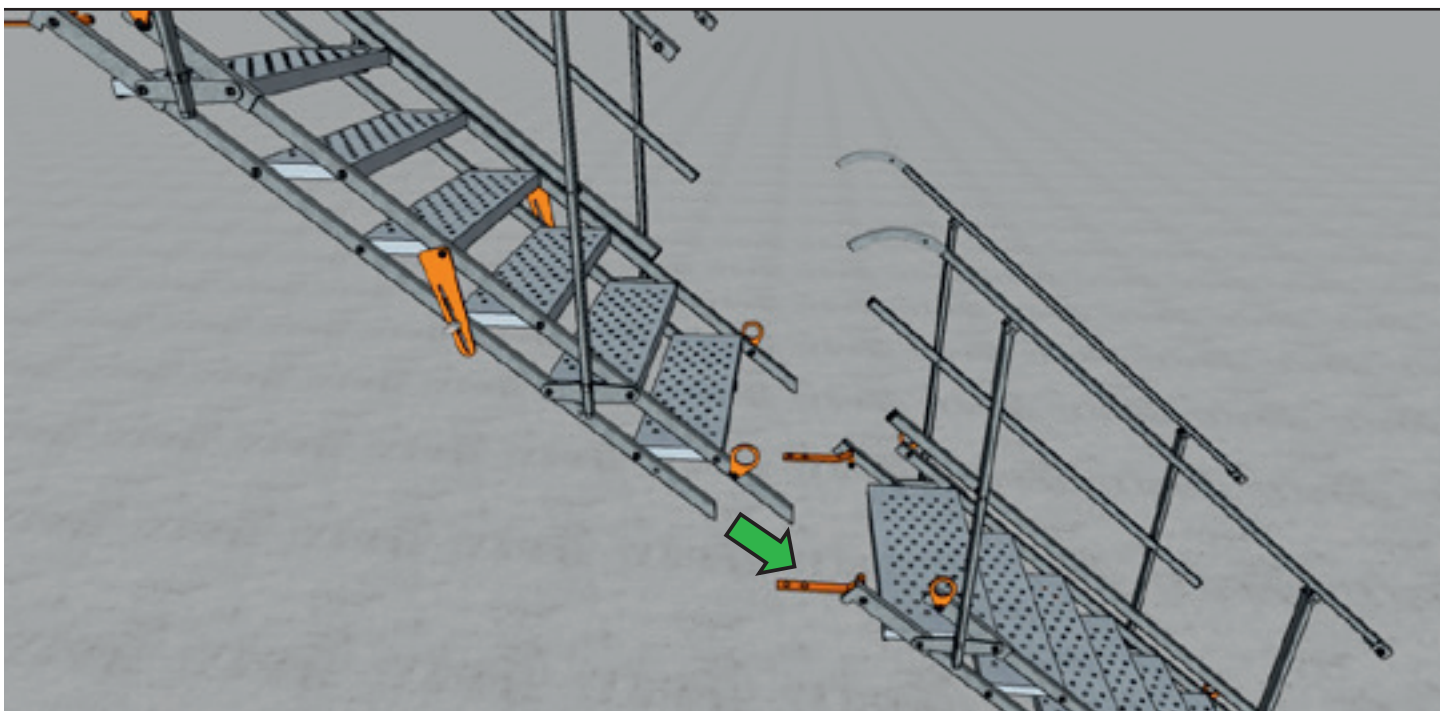
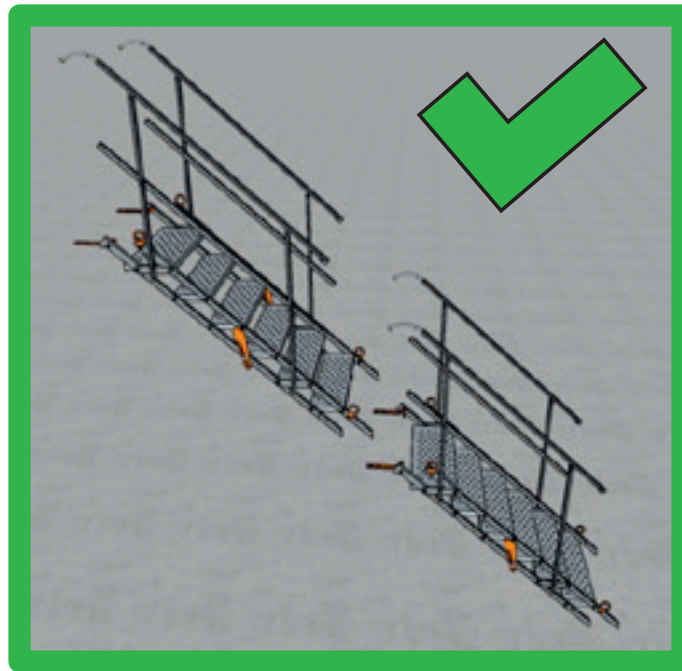

Connection 9-step Stairway with 9-step Stairway

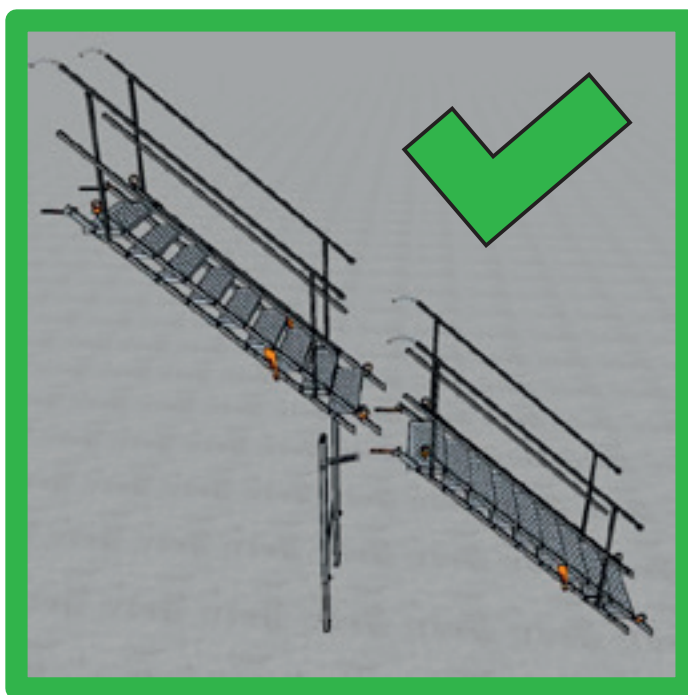

- Further support needed
- Assembly via Screws at step 10

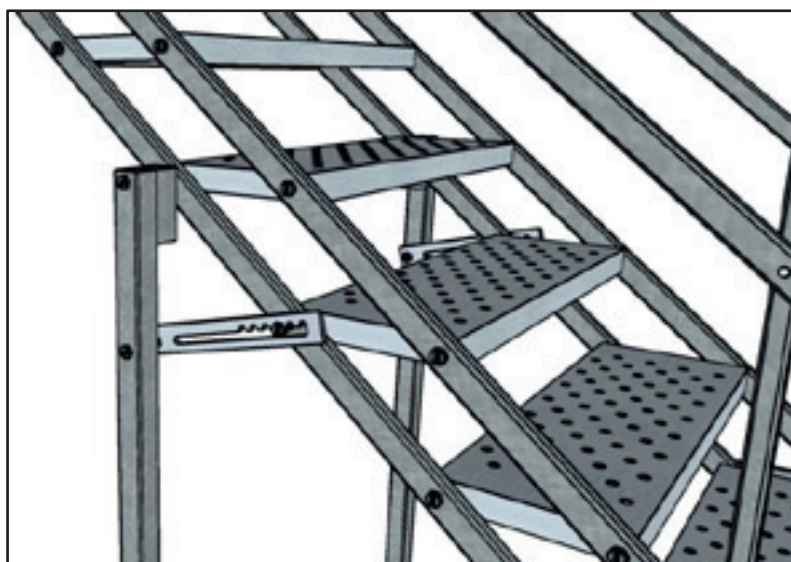

Connection 9-step Stairway with 9-step Stairway

Assembly of the support

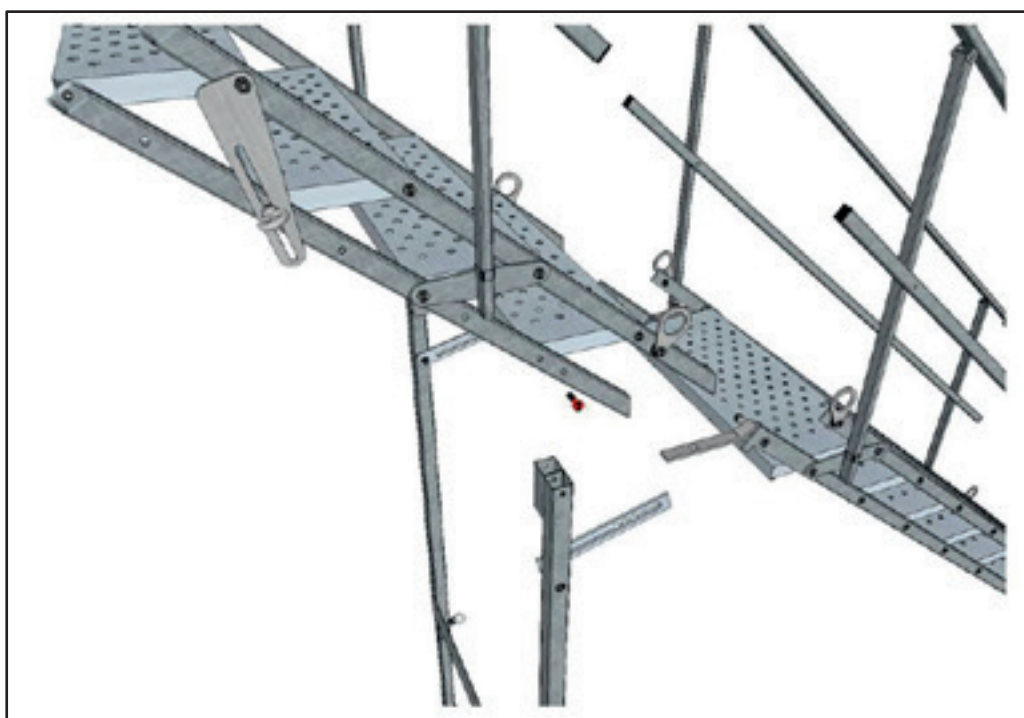

Remove bold ISO 4017 M10x35 8.8 and nut with clamping part ISO 10511 M10 8 at step 1 of the upper stairway at both lower side beams.

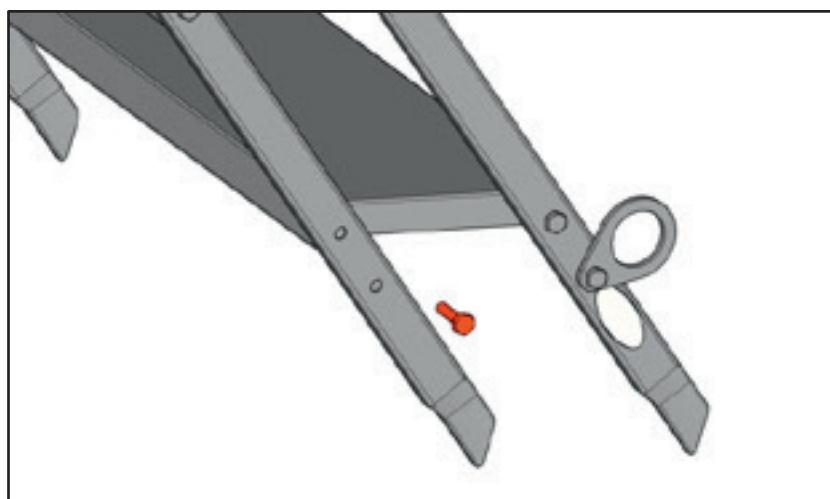

Connection 9-step Stairway with 9-step Stairway

Assembly of the support

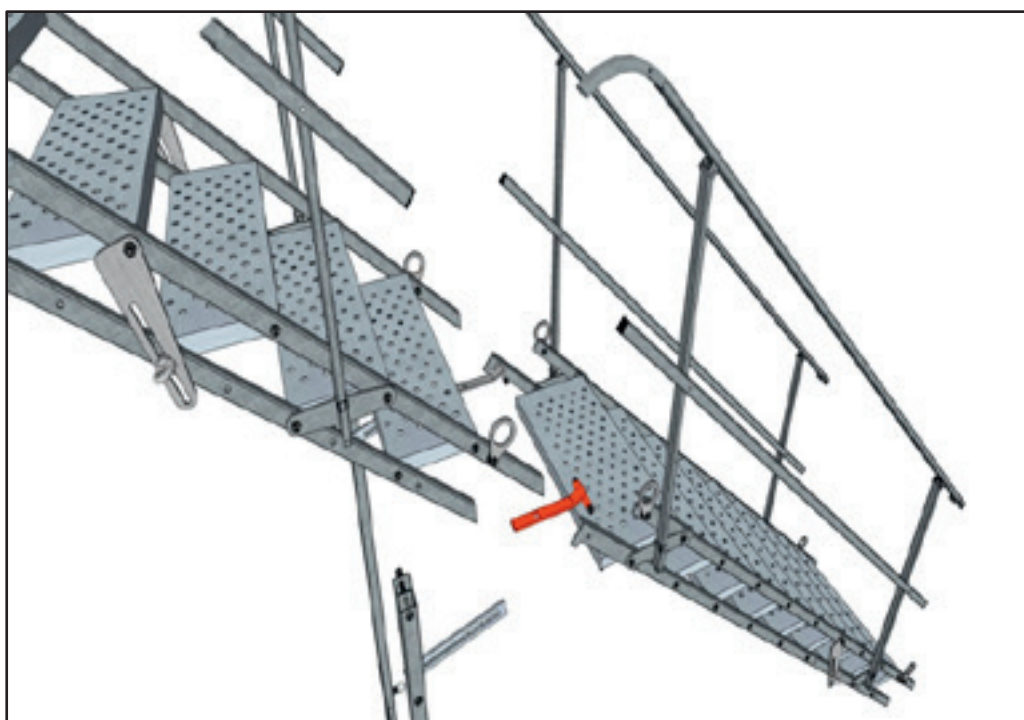

Remove bolt ISO 4017 M10x90 8.8 and nut with clamping part ISO 10511 M10 8 and the slabfix at the lower stairway on both lower side beams.

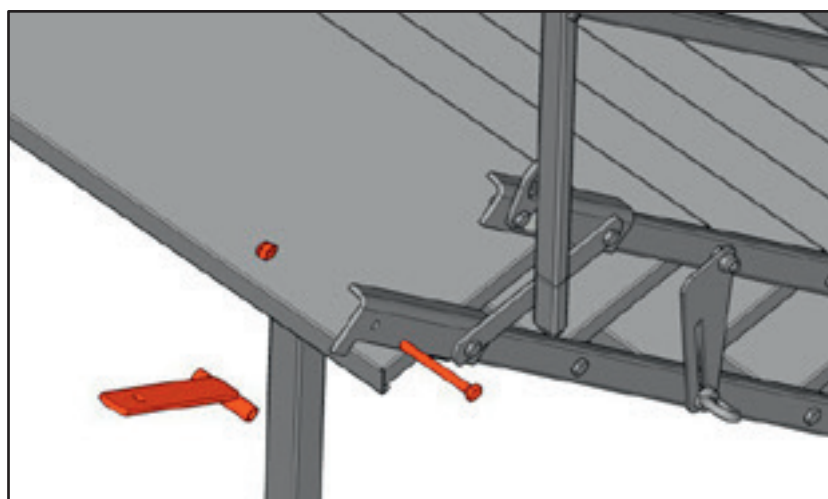

Connection 9-step Stairway with 9-step Stairway

Assembly of the support

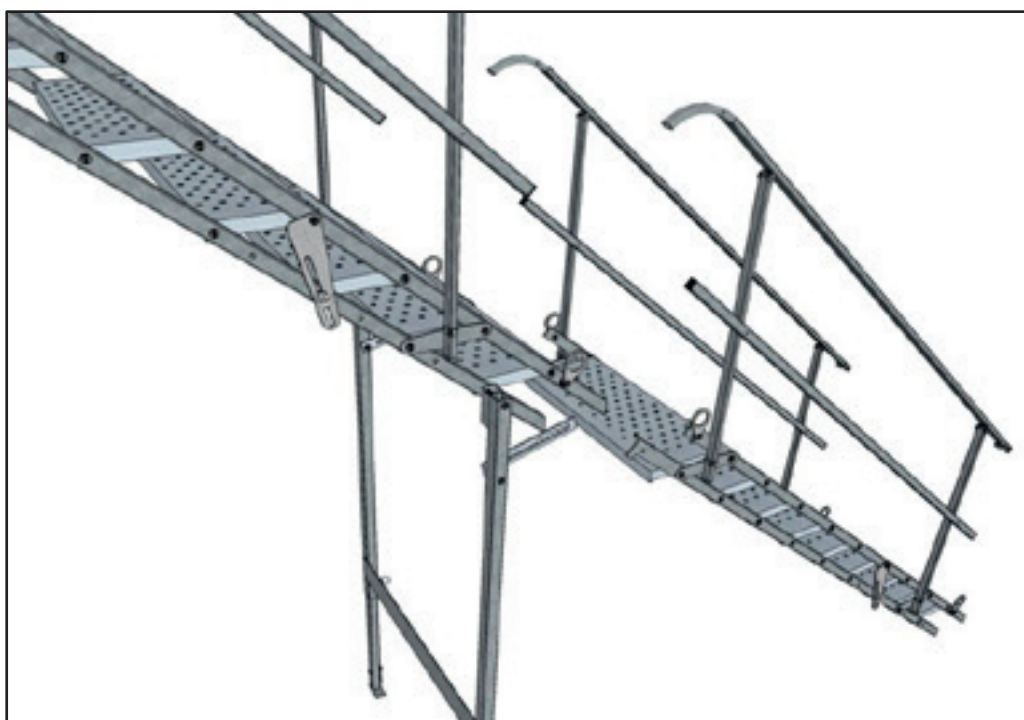

Attach the support to step 1 of the upper stairway using bolt ISO 4017 M10x120 8.8 and nut with clamping part ISO 10511 M10 8.

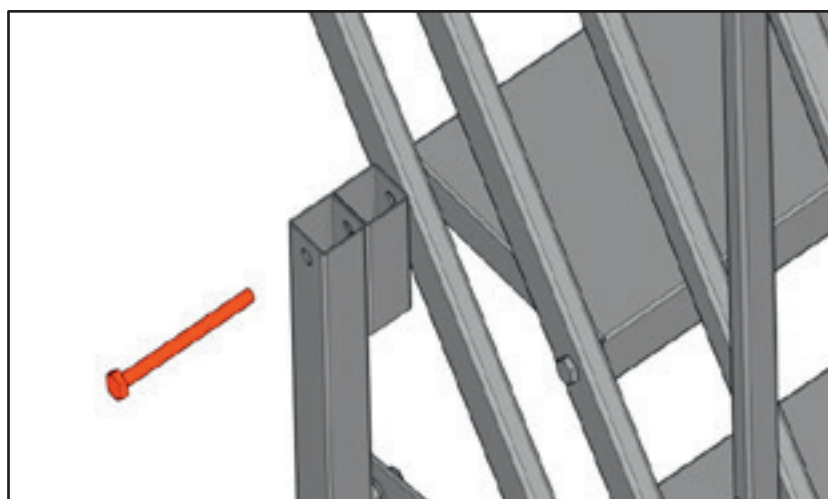

Connection 9-step Stairway with 9-step Stairway

Assembly of the support

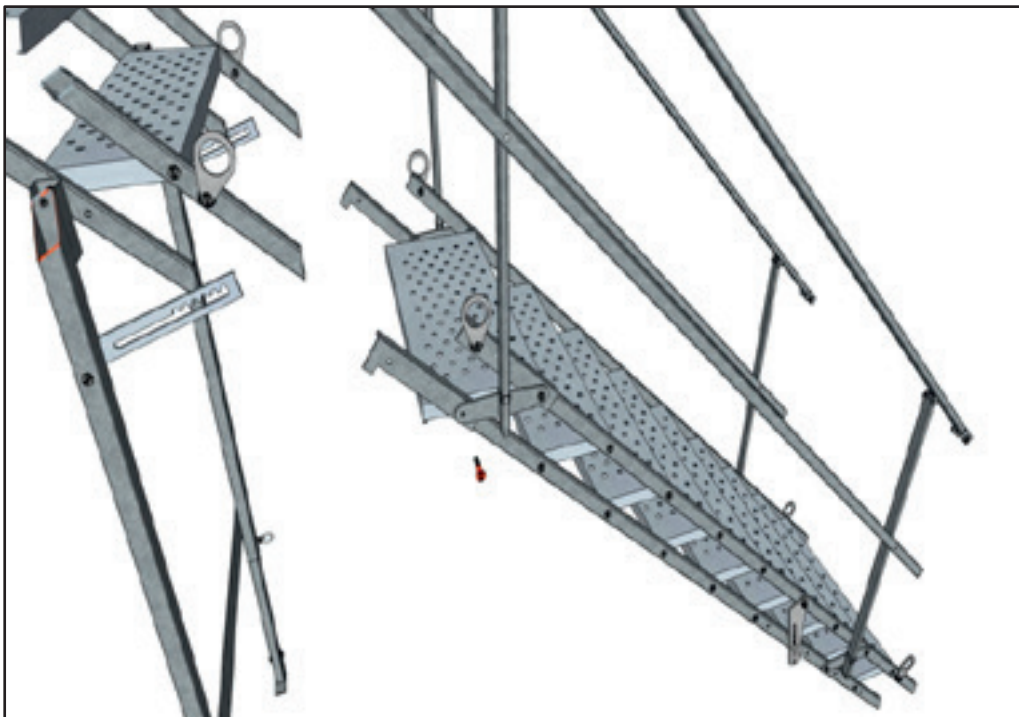

Loose bolt ISO 4017 M10x50 8.8 and nut with clamping part ISO 10511 M10 8 from step 9 of the lower side beams of the lower stairway.

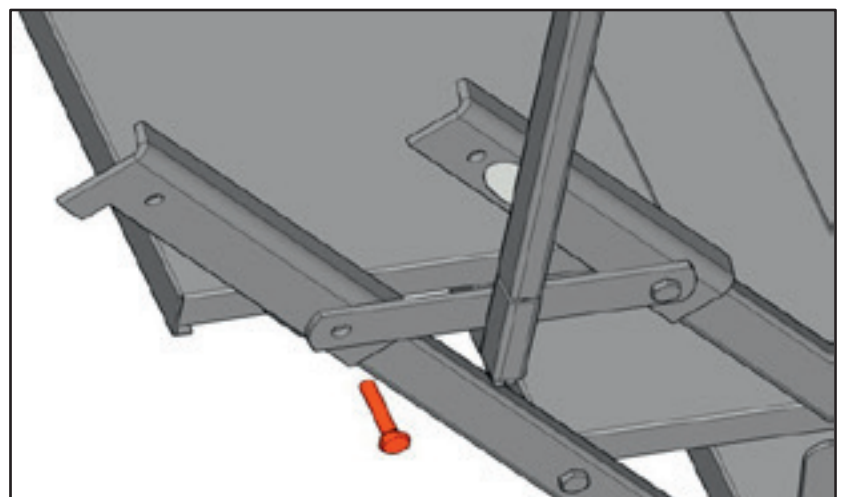

Connection 9-step Stairway with 9-step Stairway

Assembly of the support

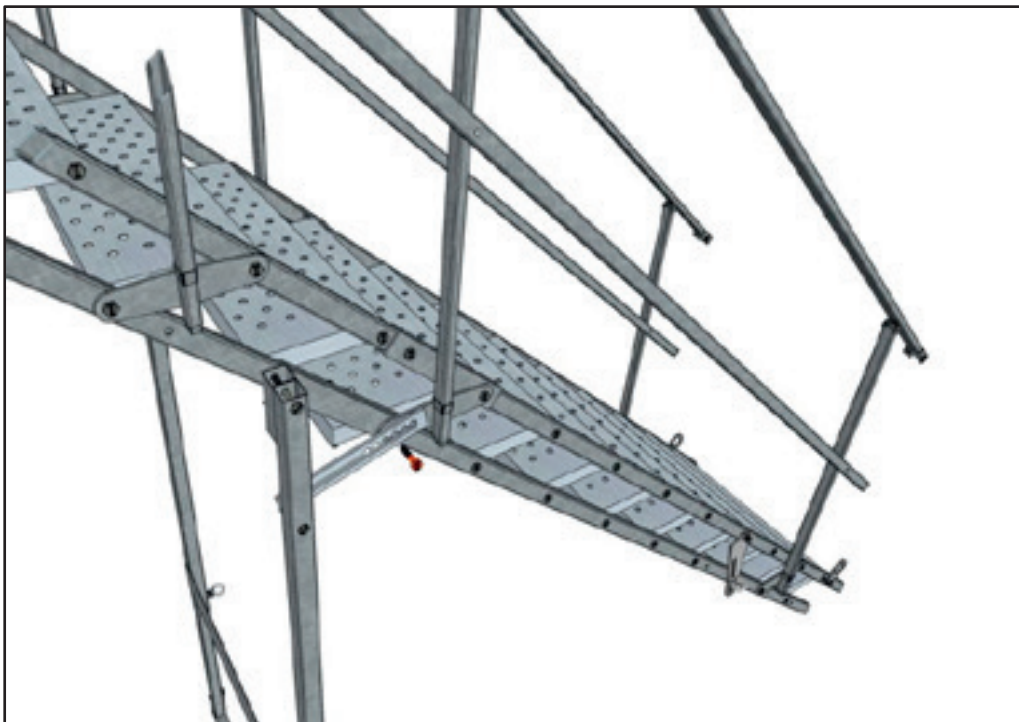

Attach the crocodiles to step 9 of the lower stairway on both sides using bolt ISO 4017 M10x60 8.8, washer ISO 7089 M10 and nut with clamping part ISO 10511 M10 8.

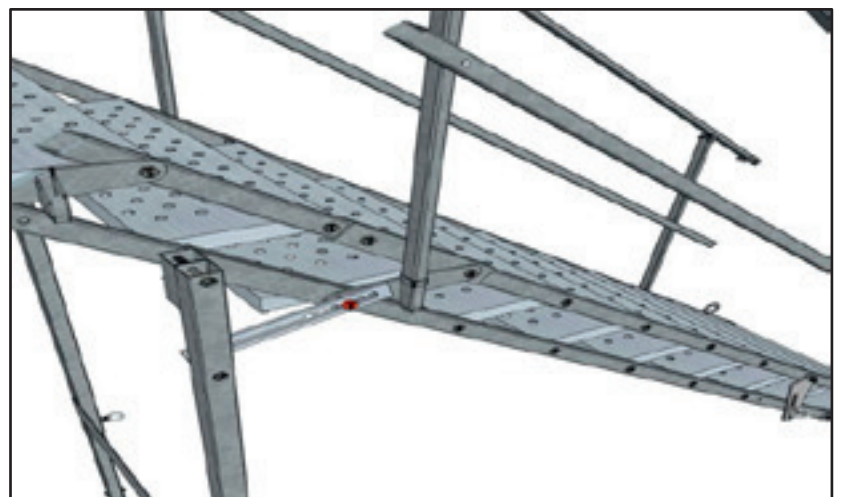

Connection 3-step Stairway with 6-step Stairway

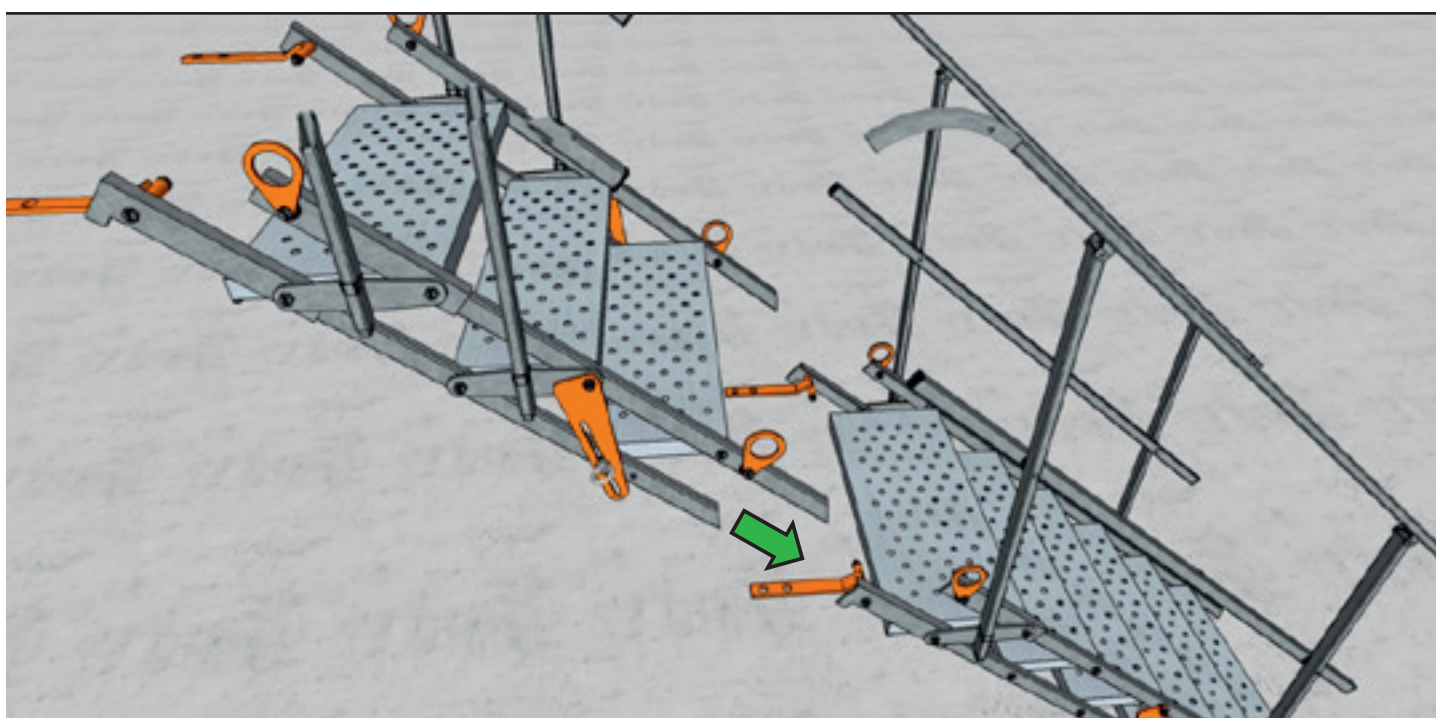
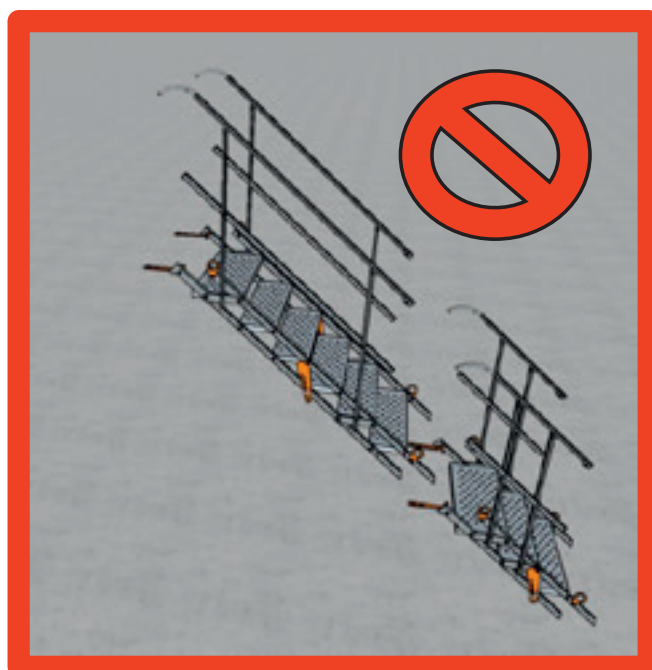
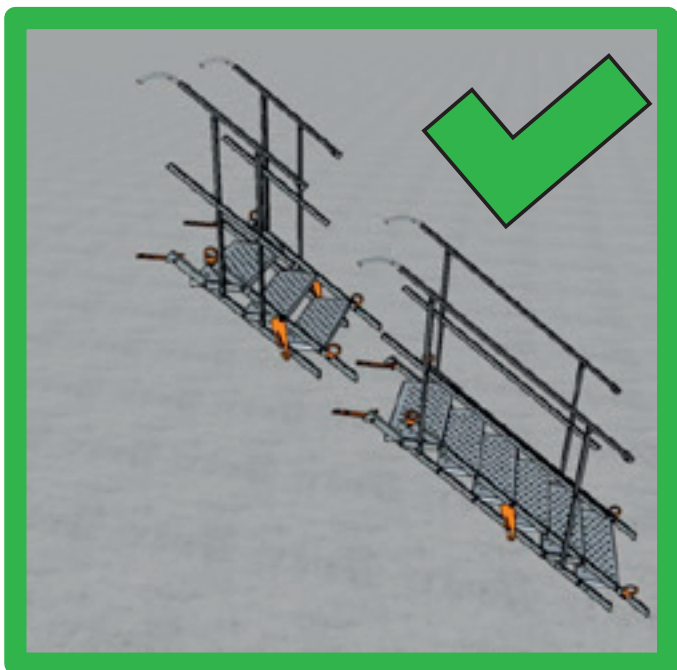

Connection 3-step Stairway with 9-step Stairway

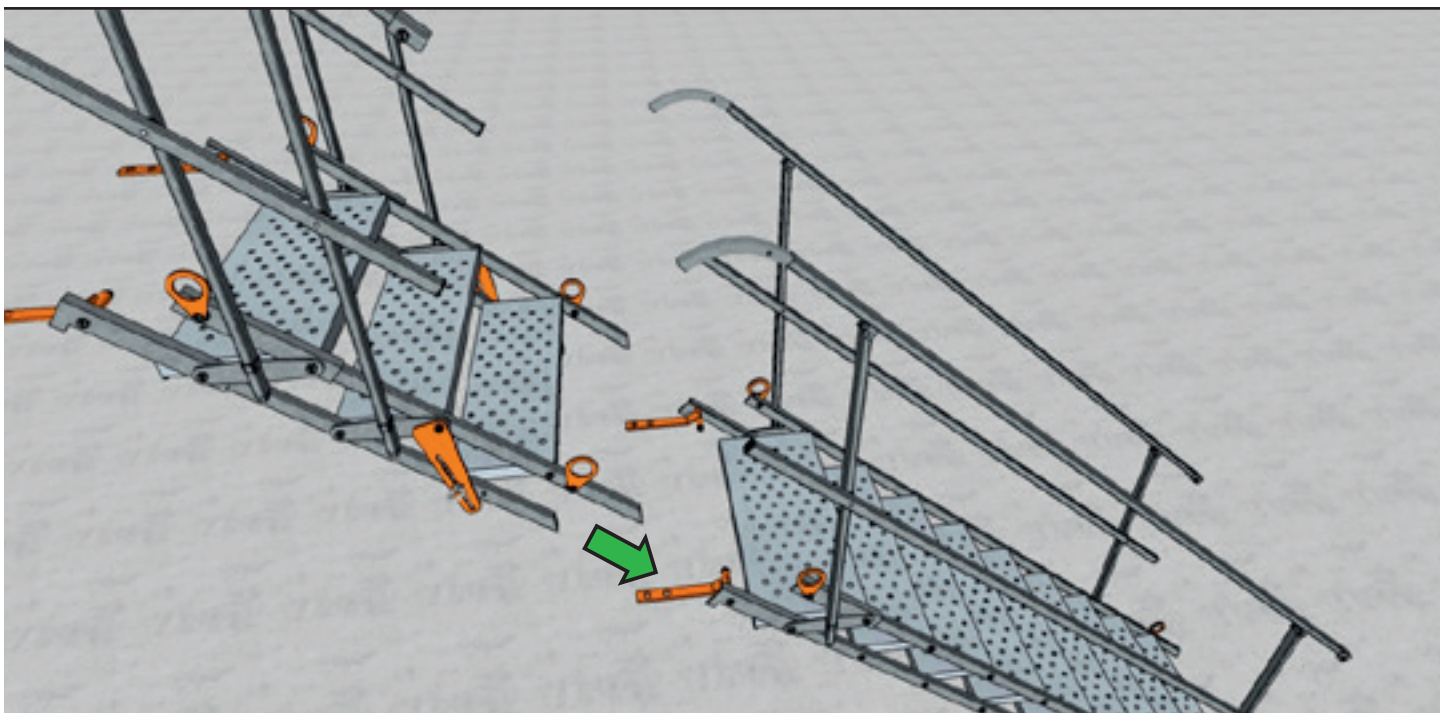
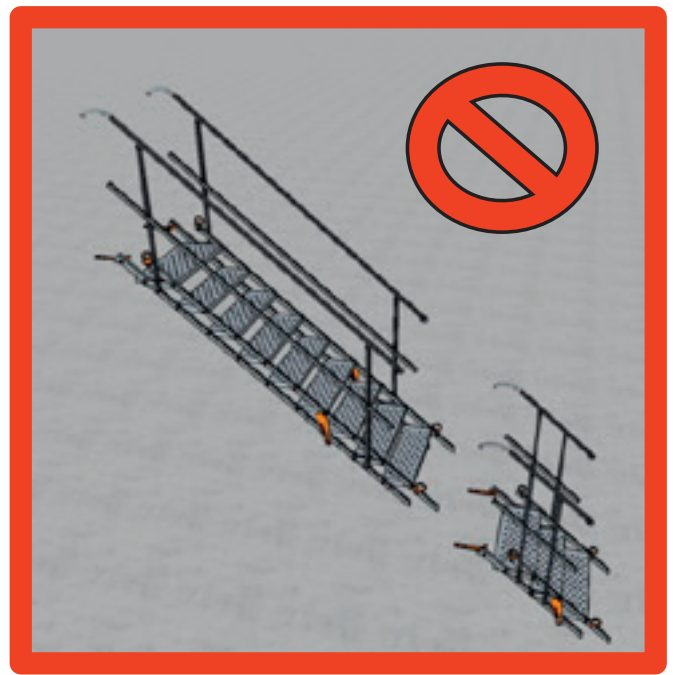
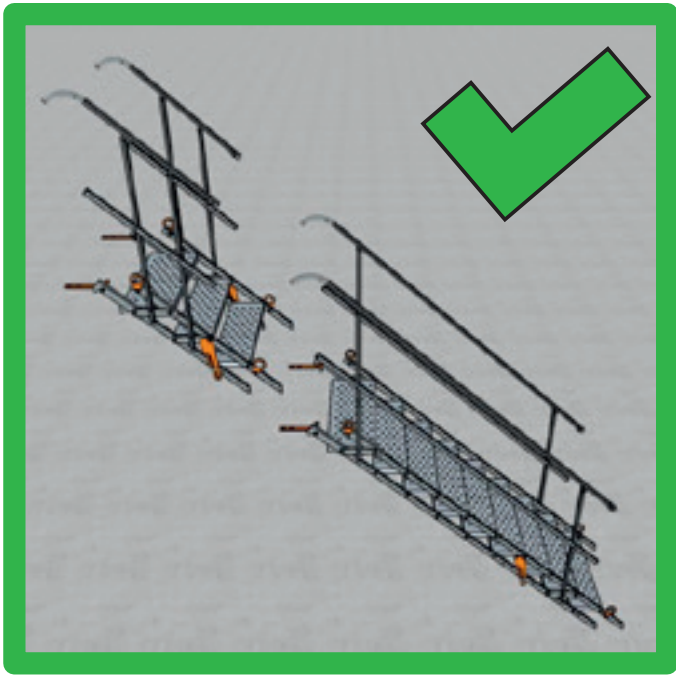

Connection 3-step Stairway with 12-step Stairway

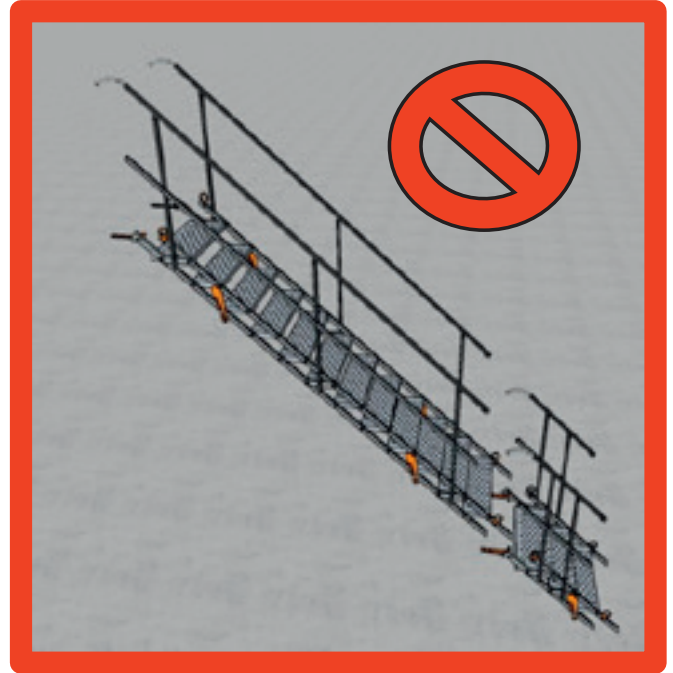
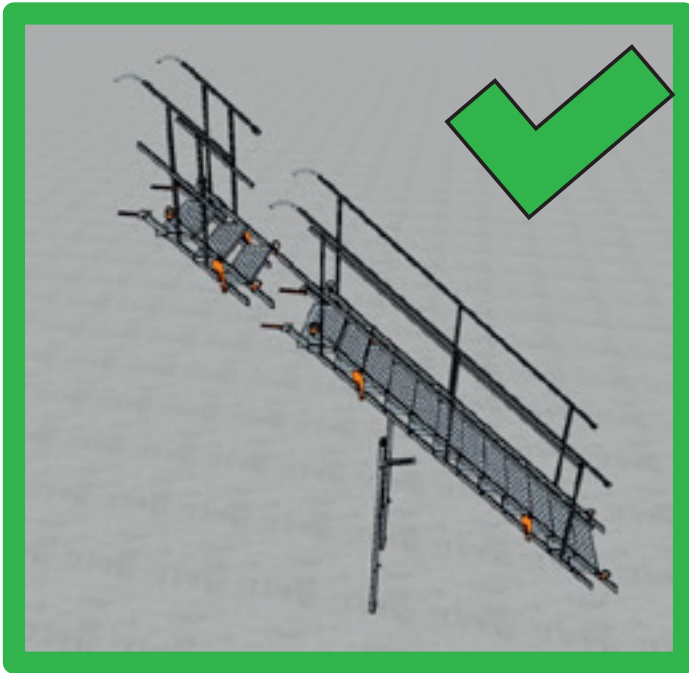

- Further support needed
- Assembly via Screws at step 9

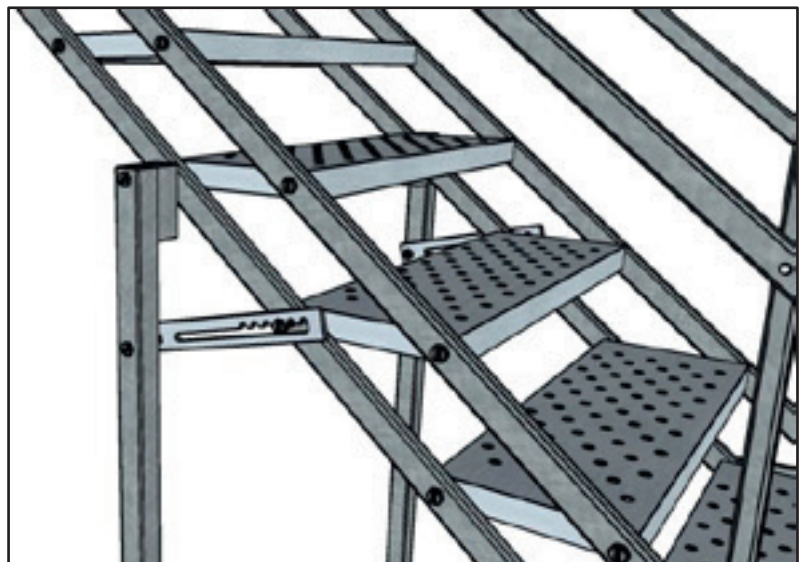

Connection 3-step Stairway with 12-step Stairway

Assembly of the support

1. Remove bolt ISO 4017 M10x35 8.8 and nut with clamping part ISO 10511 M10 8 at step 8 and 9 of the 12-step stairway on both lower side beams.

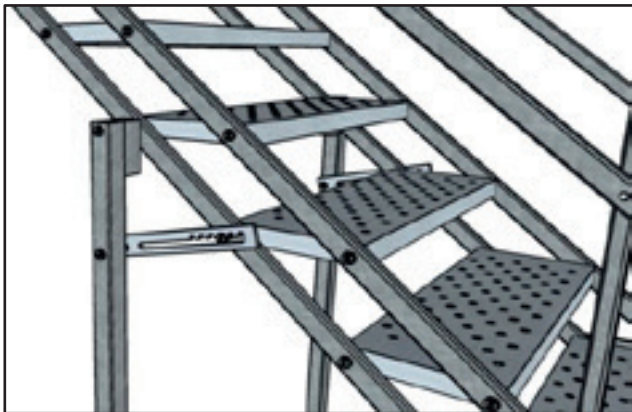

2. Attach the support using bolt ISO 4017 M10x120 8.8 and nut with clamping part ISO 10511 M10 8 at step 9 of the 12-step staircase on both lower side beams.

3. Install the crocodiles using bolt ISO 4017 M10x60 8.8, washer ISO 7089 M10 and nut with clamping part ISO 10511 M10 8 at step 8 of the 12-step stairway on both lower side beams.

Connection 3-step Stairway with 15-step Stairway

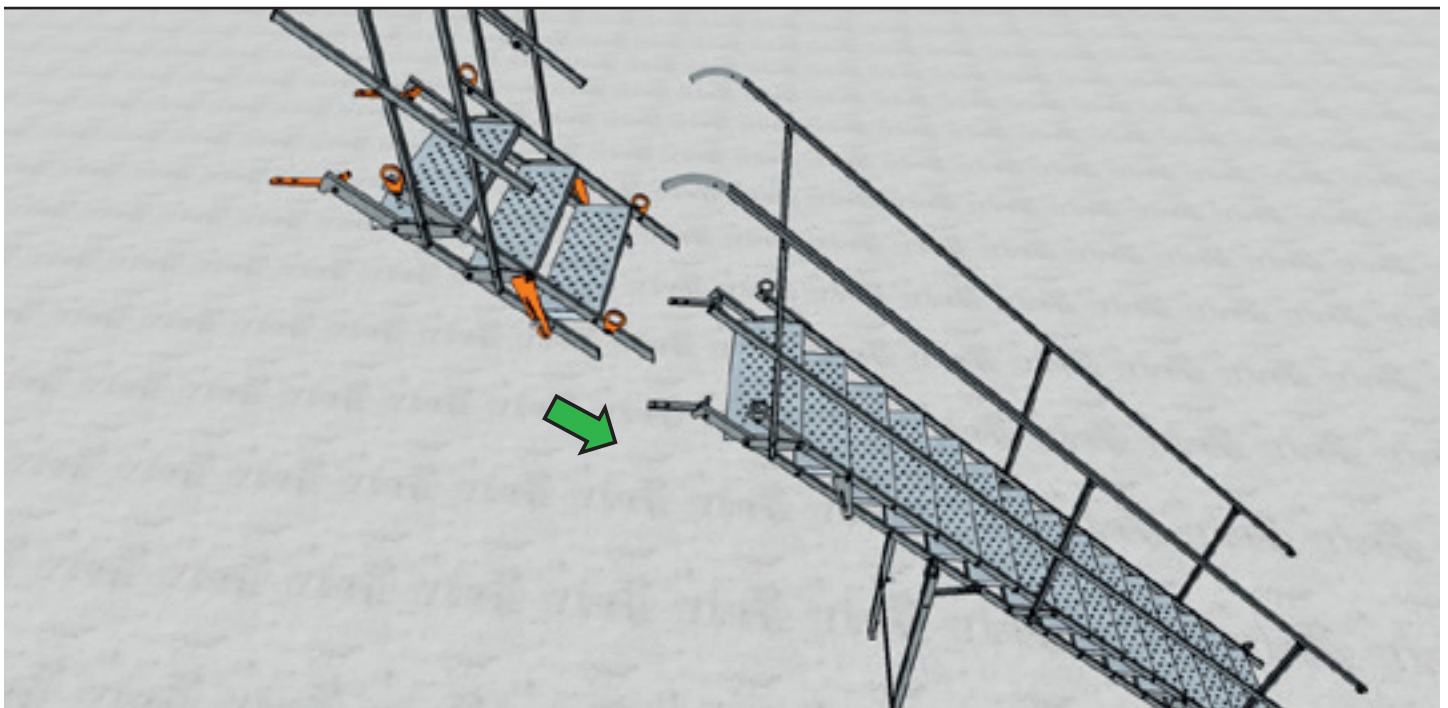
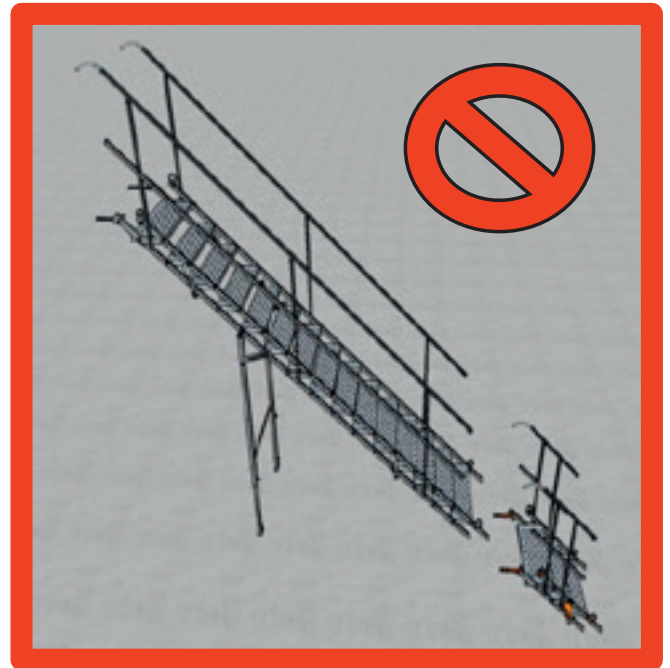
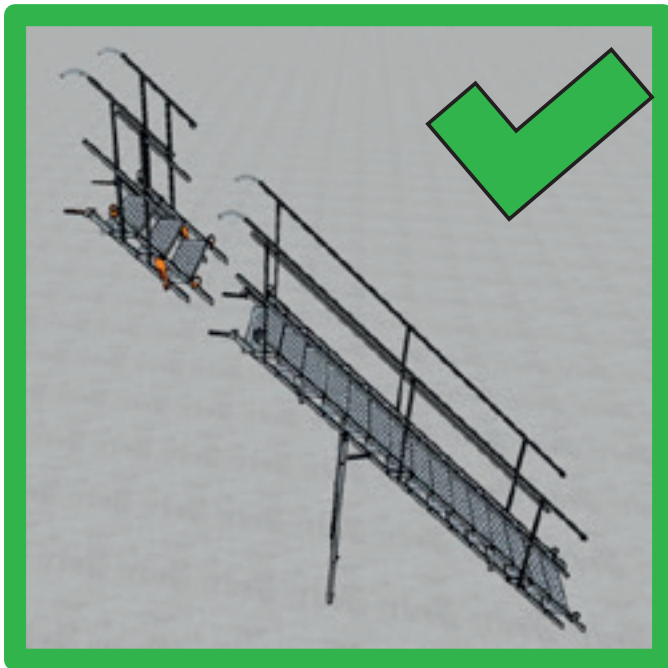

Connection 3-step Stairway with 18-step Stairway

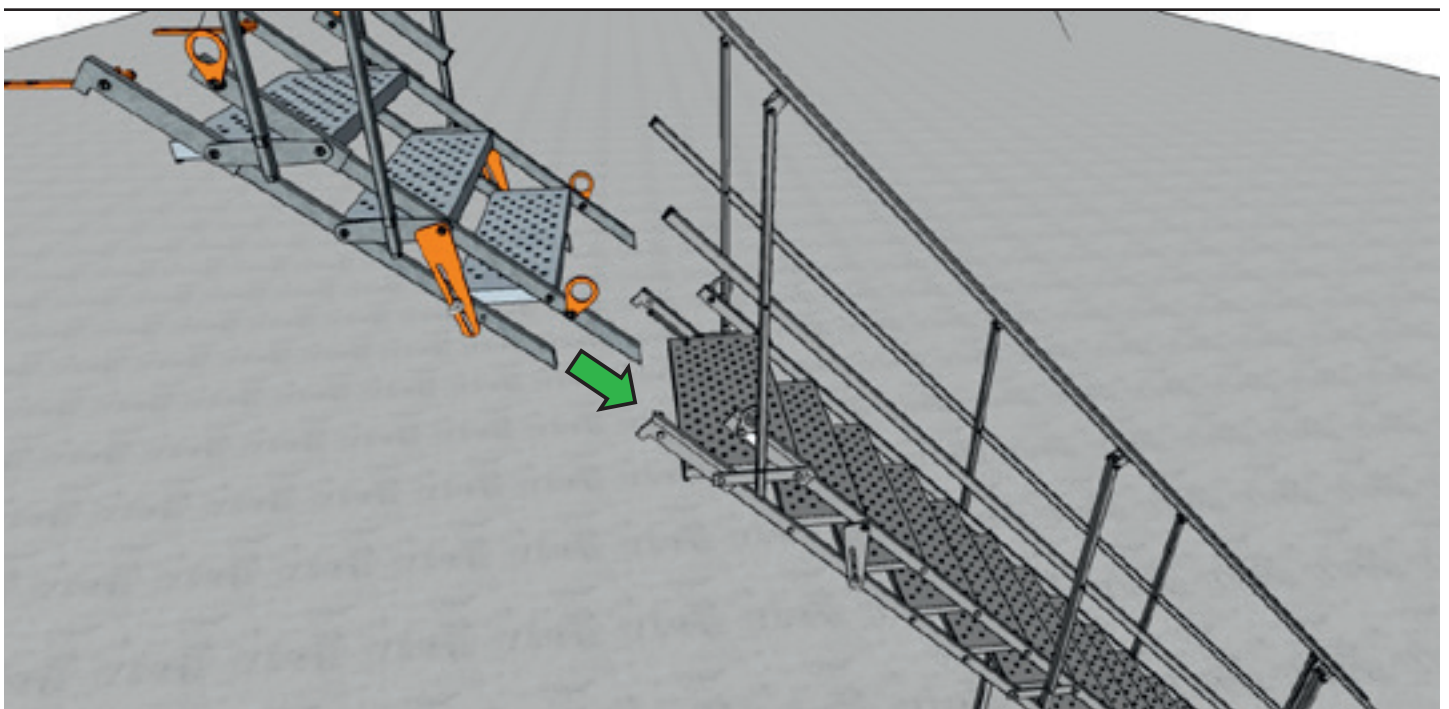
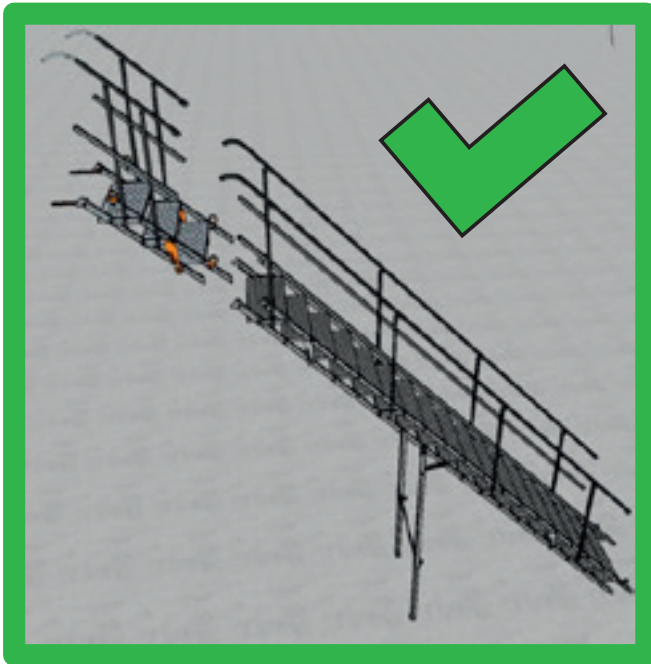

Connection 6-step Stairway with 9-step Stairway

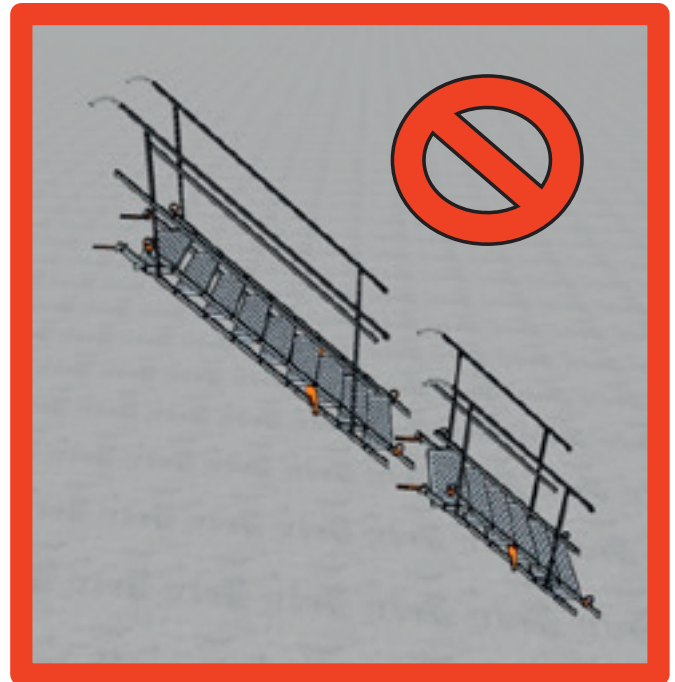
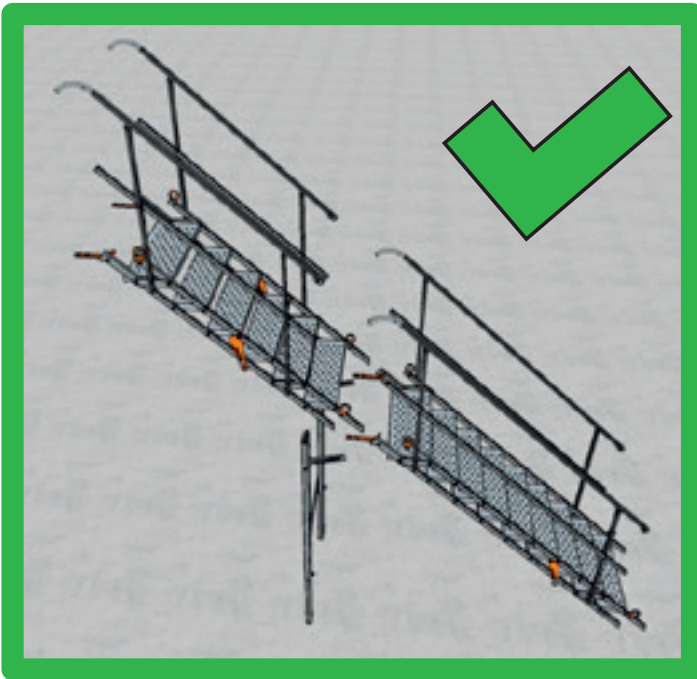

- Further support needed
- Assembly via Screws at step 10

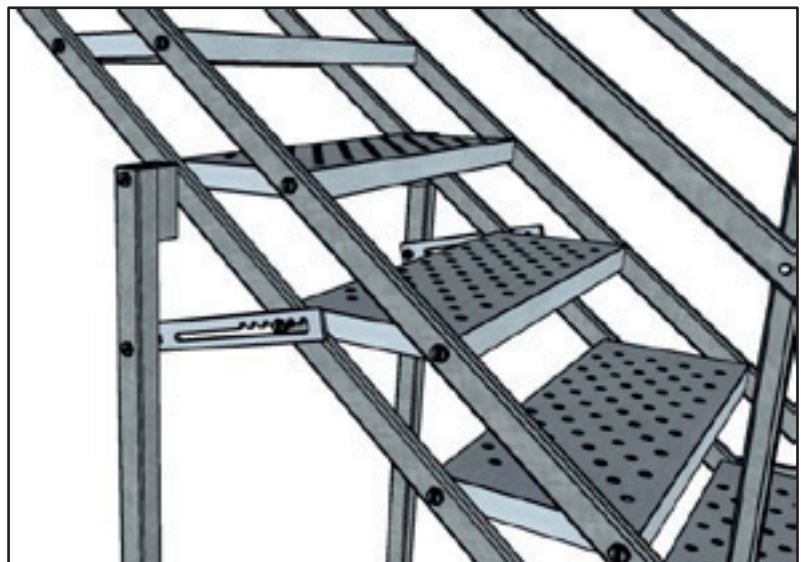

Connection 6-step Stairway with 9-step Stairway

Assembly of the support

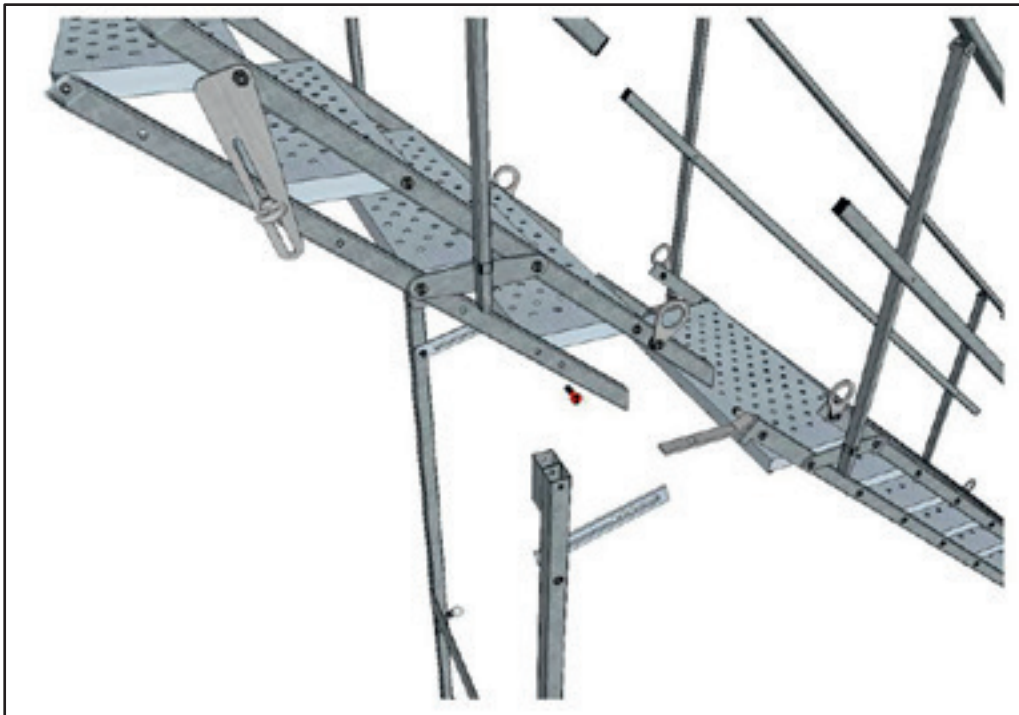

Remove bolt ISO 4017 M10x35 8.8 and nut with clamping part ISO 10511 M10 8 at step 1 of the 6-step stairway at both lower side beams.

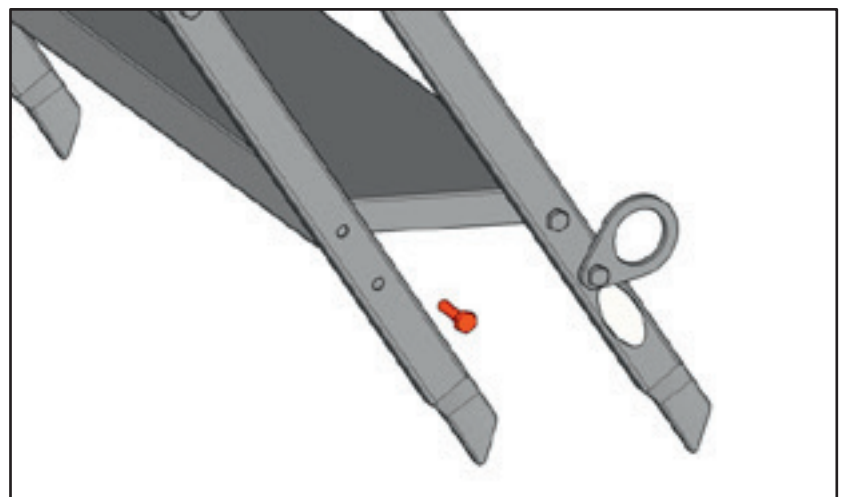

Connection 6-step Stairway with 9-step Stairway

Assembly of the support

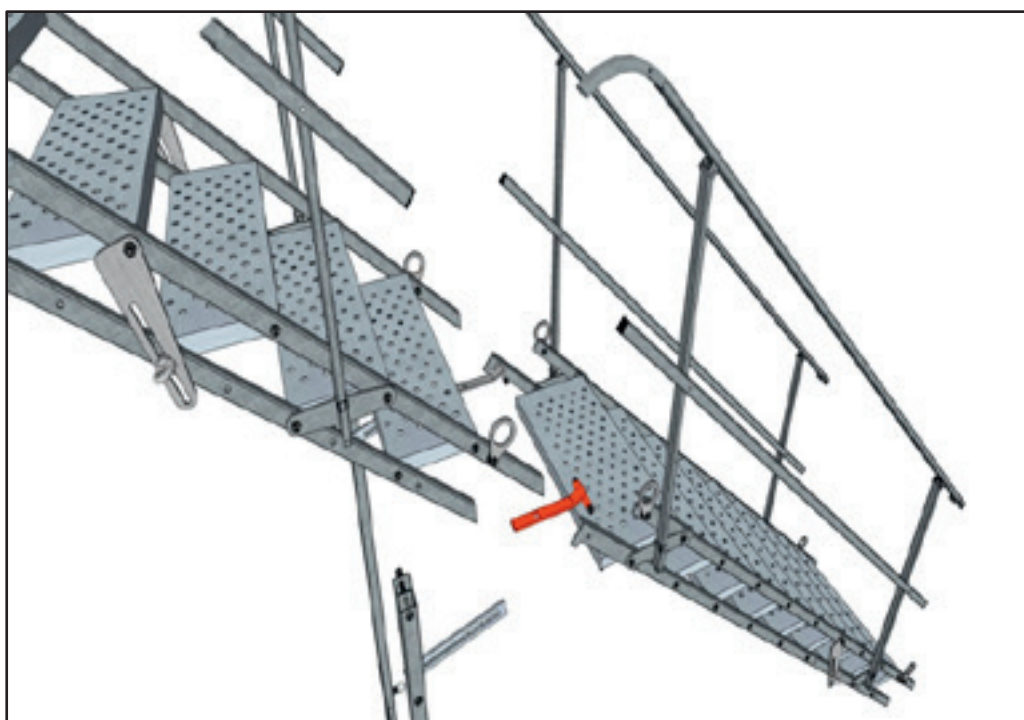

Remove bolt ISO 4017 M10x90 8.8 and nut with clamping part ISO 10511 M10 8 and the slabfix at the 9-step stairway on both lower side beams.

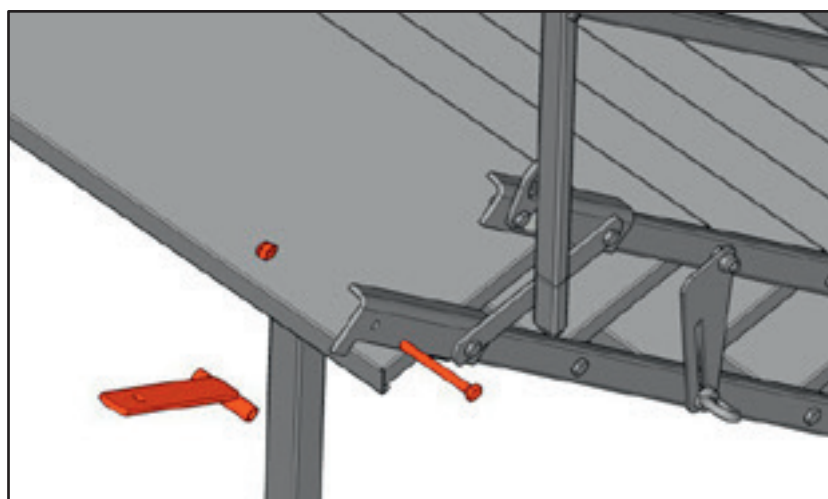

Connection 6-step Stairway with 9-step Stairway

Assembly of the support

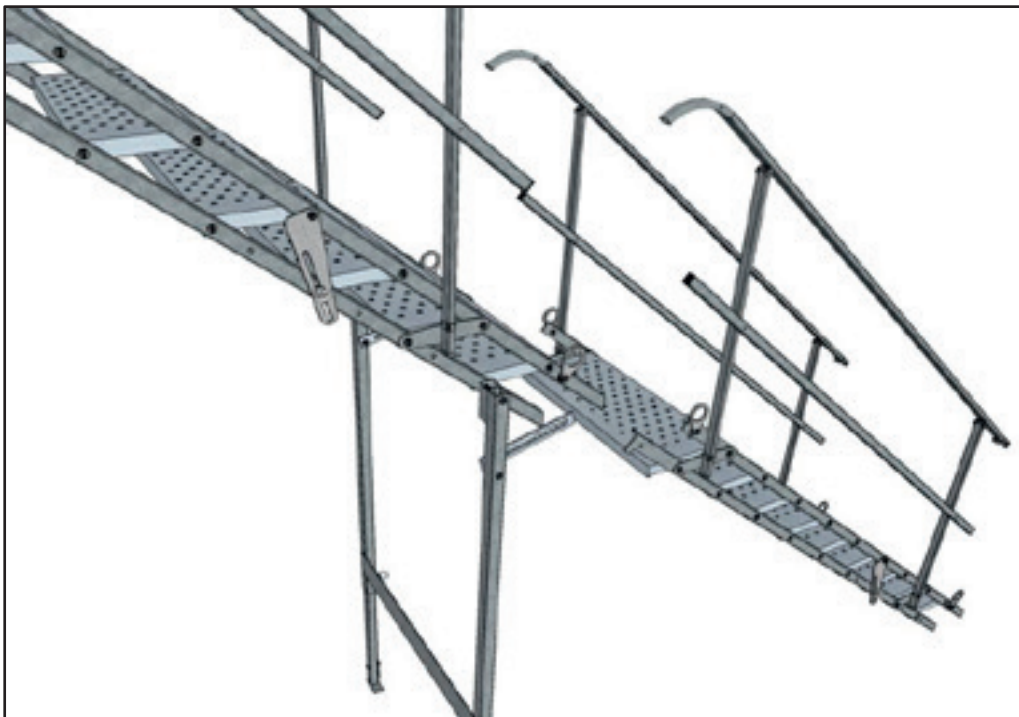

Attach the support to step 1 of the 6-step stairway using bolt ISO 4017 M10x120 8.8 and nut with clamping part ISO 10511 M10 8.

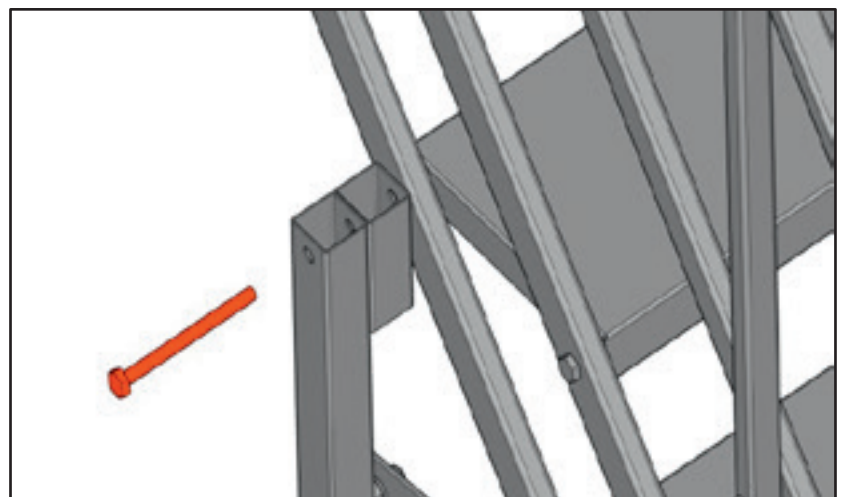

Connection 6-step Stairway with 9-step Stairway

Assembly of the support

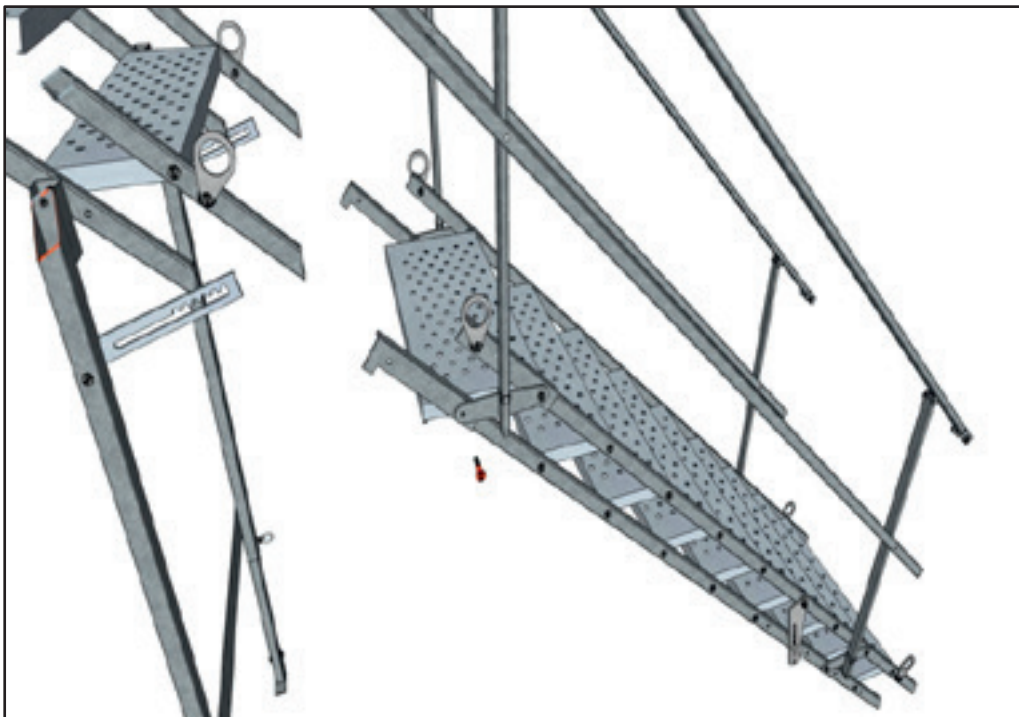

Loose bolt ISO 4017 M10x50 8.8 and nut with clamping part ISO 10511 M10 8 from step 9 of the lower side beams of the 9-step stairway .

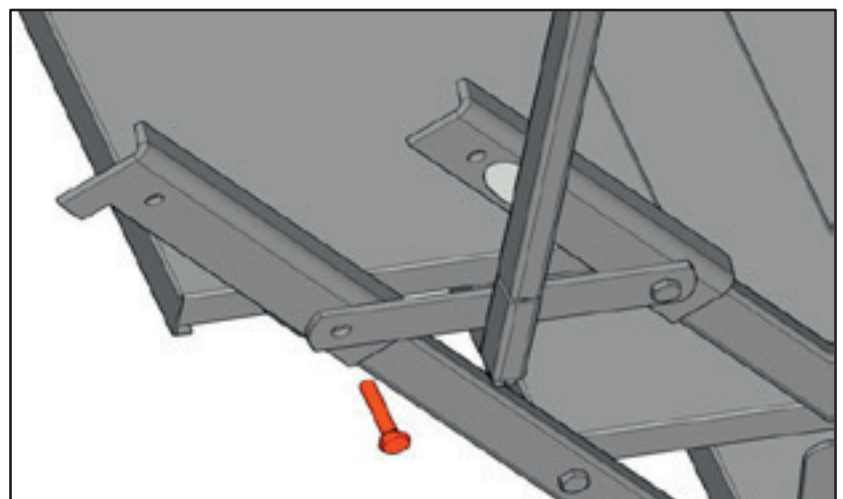

Connection 6-step Stairway with 9-step Stairway

Assembly of the support

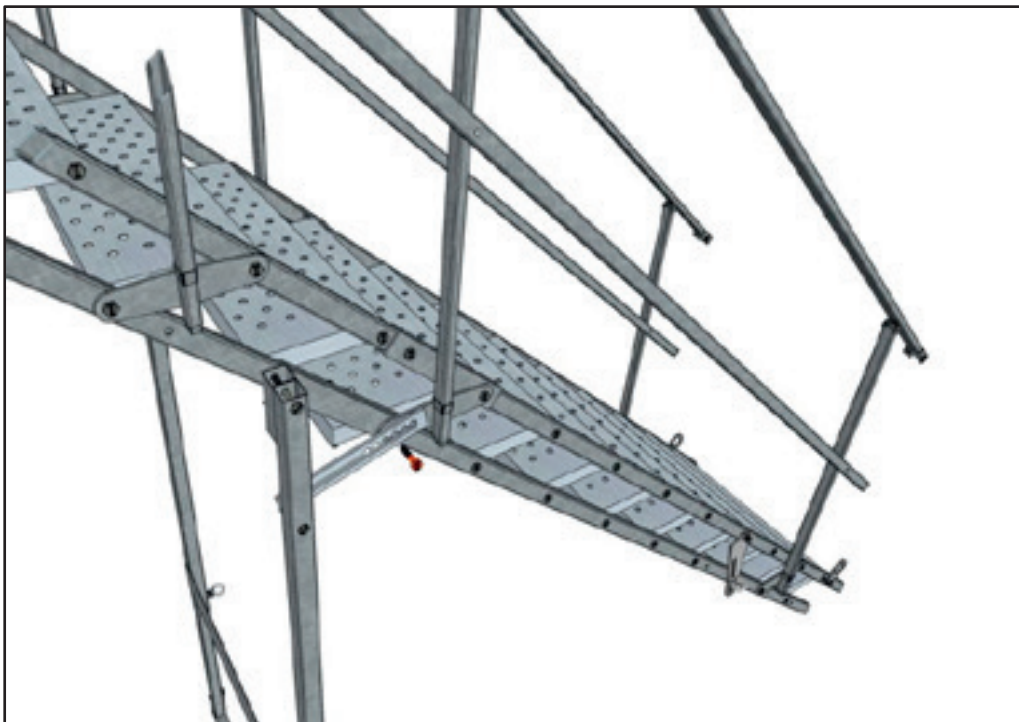

Attach the crocodiles to step 9 of the 9-step stairway on both sides using bolt ISO 4017 M10x60 8.8, washer ISO 7089 M10 and nut with clamping part ISO 10511 M10 8.

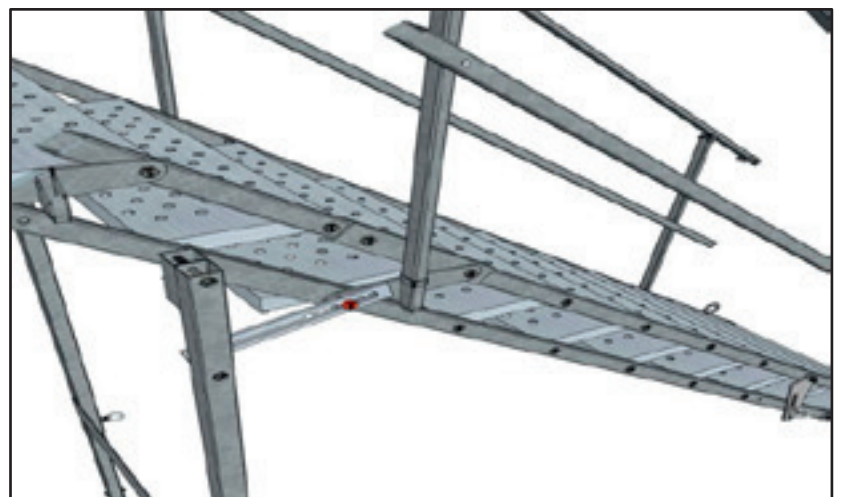

Connection 6-step Stairway with 12-step Stairway

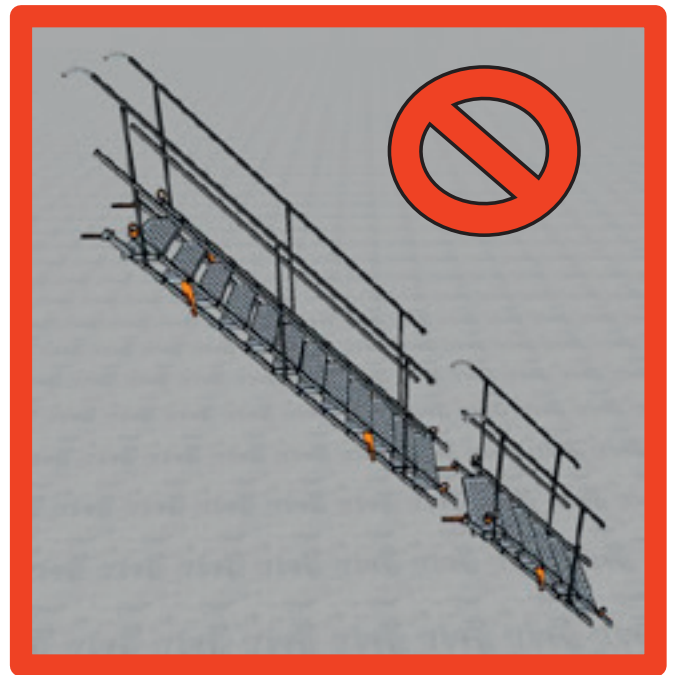
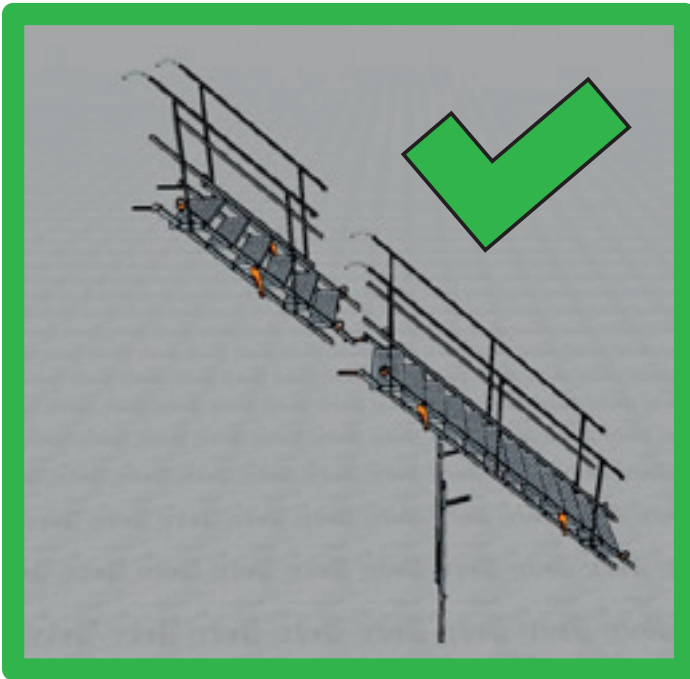

- Further support needed
- Assembly via Screws at step 9

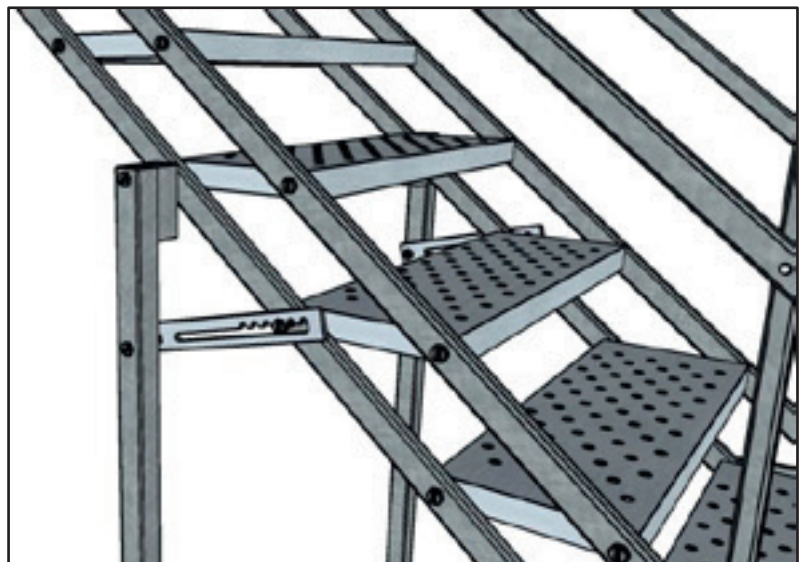

Connection 6-step Stairway with 12-step Stairway

Assembly of the support

1. Remove bolt ISO 4017 M10x35 8.8 and nut with clamping part ISO 10511 M10 8 at step 8 and 9 of the 12-step stairway on both lower side beams.

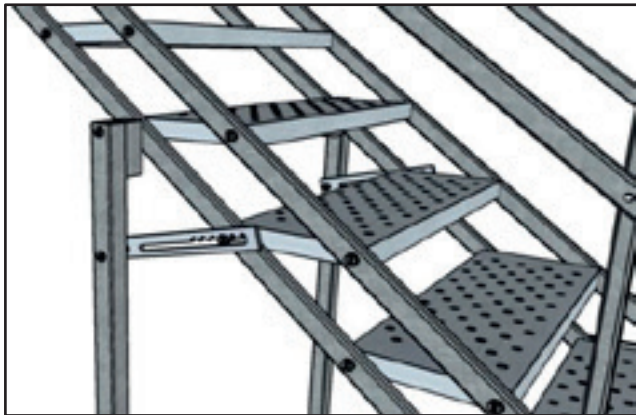

2. Attach the support using bolt ISO 4017 M10x120 8.8 and nut with clamping part ISO 10511 M10 8 at step 9 of the 12-step staircase on both lower side beams.

3. Install the crocodiles using bolt ISO 4017 M10x60 8.8, washer ISO 7089 M10 and nut with clamping part ISO 10511 M10 8 at step 8 of the 12-step stairway on both lower side beams.

Connection 6-step Stairway with 15-step Stairway

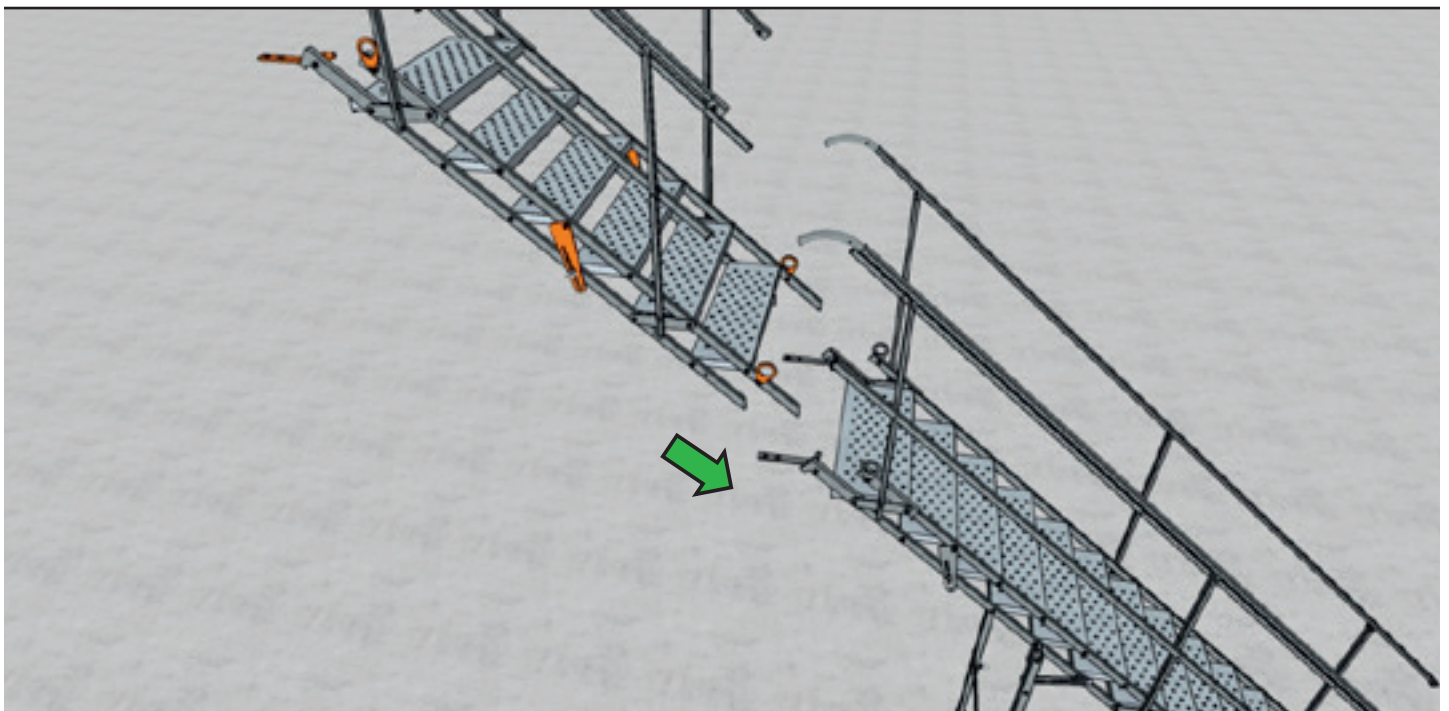
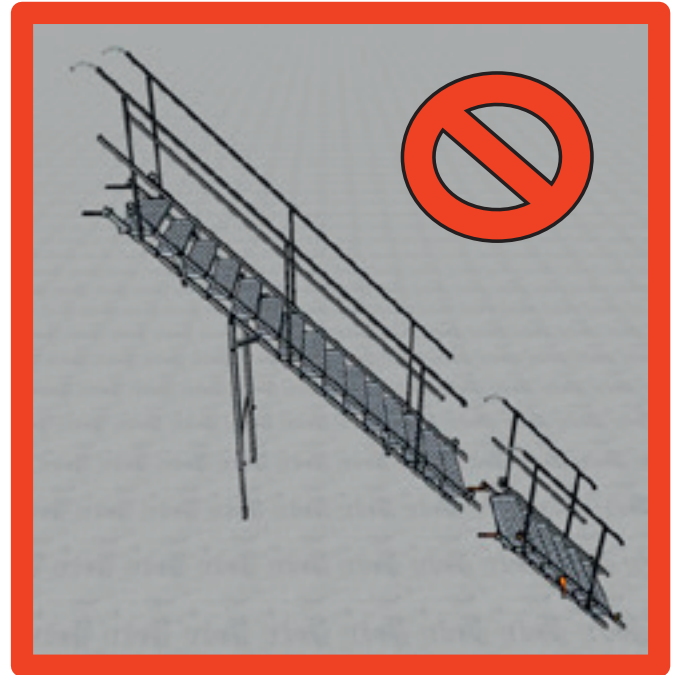
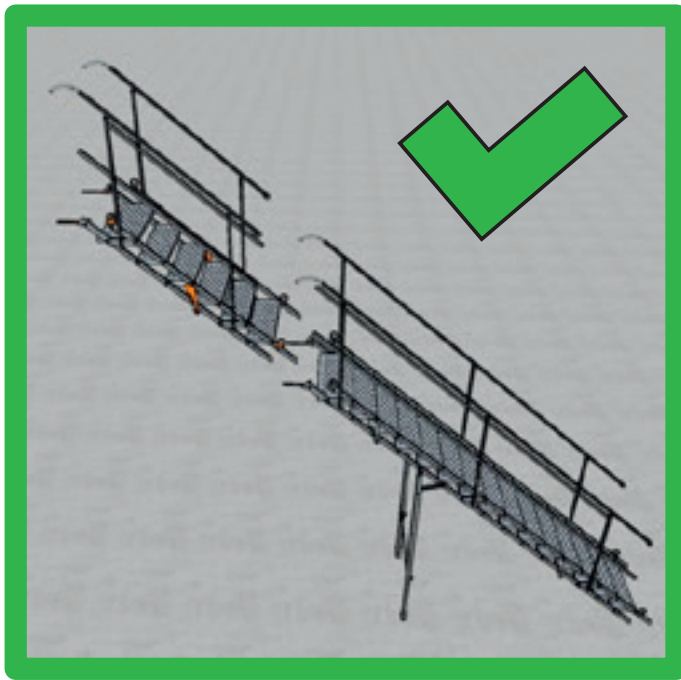

Connection 9-step Stairway with 12-step Stairway

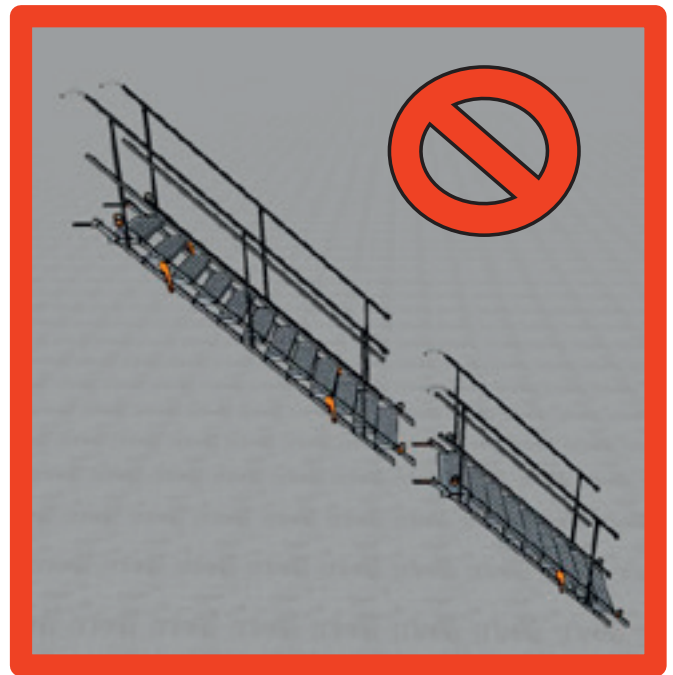
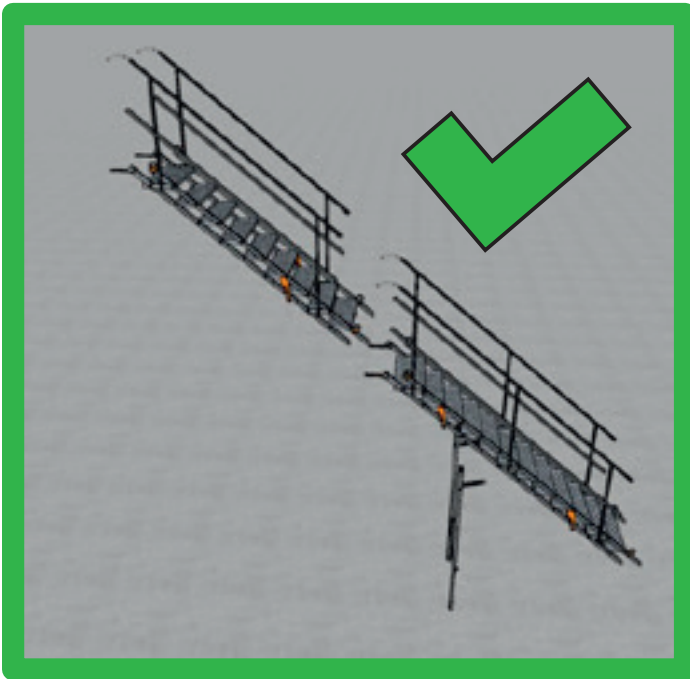

- Further support needed
- Assembly via Screws at step 9

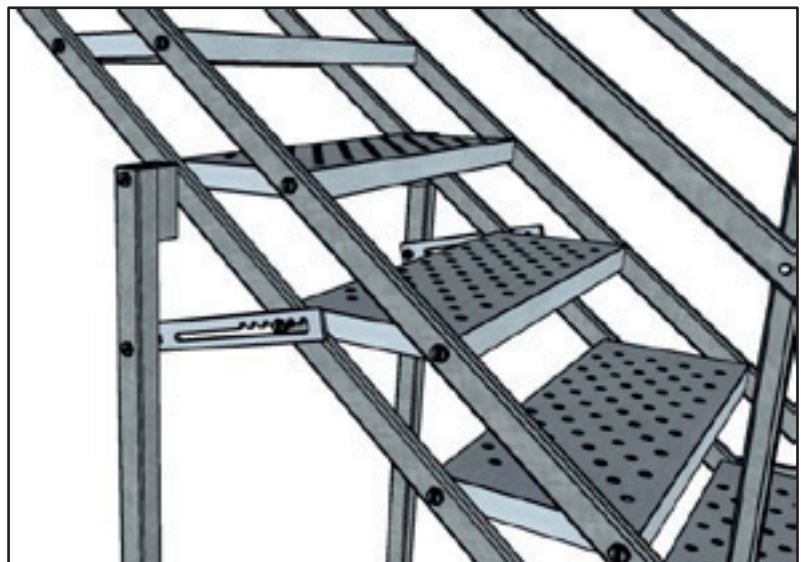

Connection 9-step Stairway with 12-step Stairway

Assembly of the support

1. Remove bolt ISO 4017 M10x35 8.8 and nut with clamping part ISO 10511 M10 8 at step 8 and 9 of the 12-step stairway on both lower side beams.

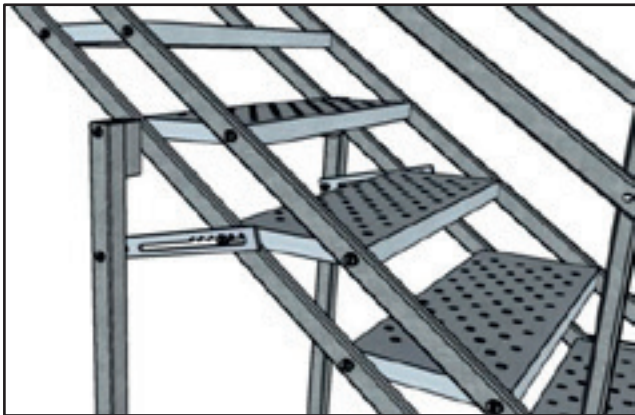

2. Attach the support using bolt ISO 4017 M10x120 8.8 and nut with clamping part ISO 10511 M10 8 at step 9 of the 12-step staircase on both lower side beams.

3. Install the crocodiles using bolt ISO 4017 M10x60 8.8, washer ISO 7089 M10 and nut with clamping part ISO 10511 M10 8 at step 8 of the 12-step stairway on both lower side beams.

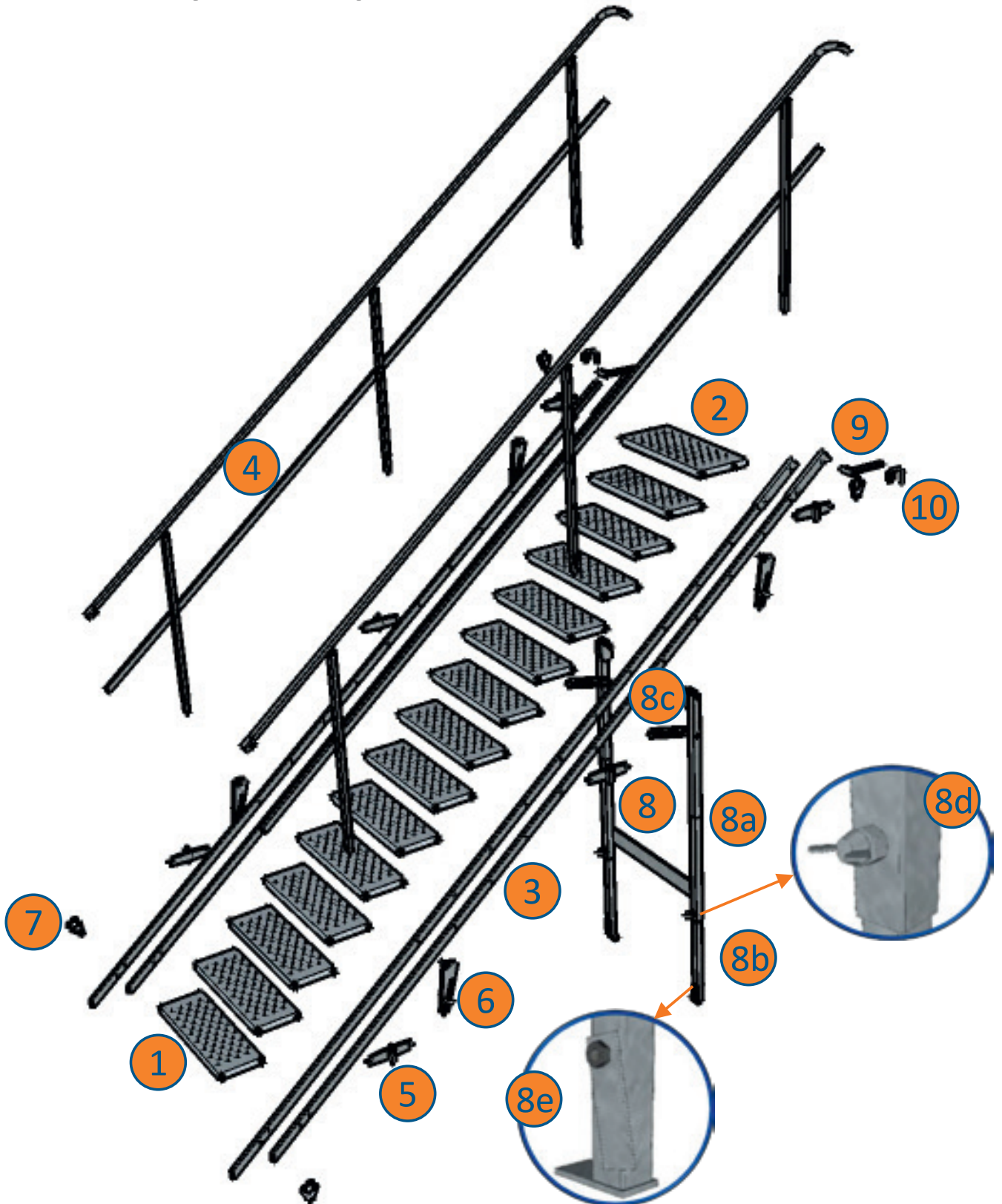

Stairway Components



Description of Stairway Components

	Item No.	Description
1.	5161010 (5161012)	Standard Step 700 (Standard Step 1000)
2.	5161011 (5161013)	Big Step 700 (Big Step 1000)
3.	5161031 5161061 5161091 5161121 5161151 5161181	Side Beam 3-step Stairway (Set = 4 pcs) Side Beam 6-step Stairway (Set = 4 pcs) Side Beam 9-step Stairway (Set = 4 pcs) Side Beam 12-step Stairway (Set = 4 pcs) Side Beam 15-step Stairway (Set = 4 pcs) Side Beam 18-step Stairway (Set = 4 pcs)
4.	5161036 5161066 5161096 5161126 5161156 5161186	Handrail 3-step Stairway (Set = 2 pcs) Handrail 6-step Stairway (Set = 2 pcs) Handrail 9-step Stairway (Set = 2 pcs) Handrail 12-step Stairway (Set = 2 pcs) Handrail 15-step Stairway (Set = 2 pcs) Handrail 18-step Stairway (Set = 2 pcs)
5.	5161004	Handrail Holder
6.	5161003	Stair Lock
7.	5161002	Crane Hook
8.	5061001 (5061005)	Stairway Support 700 (consists of 8a-8e) (Stairway Support 1000)
8a.	50610015 (5061005)	Stairway Support Body 700 (Stairway Support Body 1000)
8b.	50610014	Inner Tube for Stairway Support
8c.	50610019	Crocodile Connector
8d.	00013	Wing Screw for Stairway Support
8e.	50610016	Lock for Stairway Support
9.	5161001	Slabfix for Stairway
10.	5061103	Scaffoldfix for Stairway

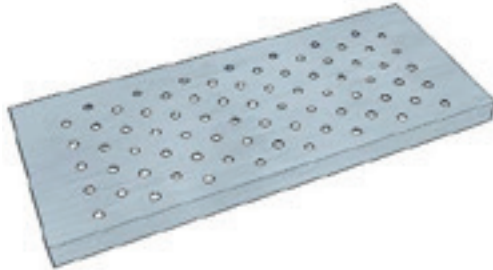
Illustration of Stairway Components

Item No.	Description	Illustration
5161010	Standard Step Stairway 700	
5161012	Standard Step Stairway 1000	
5161011	Big Step Stairway 700	
5161013	Big Step Stairway 1000	
5161031 5161061 5161091 5161121 5161151 5161181	Side Beams: 3-step Stairway 6-step Stairway 9-step Stairway 12-step Stairway 15-step Stairway 18-step Stairway	
5161036 5161066 5161096 5161126 5161156 5161186	Handrails: 3-step Stairway 6-step Stairway 9-step Stairway 12-step Stairway 15-step Stairway 18-step Stairway	

Item No.	Description	Illustration
5161004	Handrail Holder	
5161003	Stair Lock	
5161002	Crane Hook	
5061001	Stairway Support 700	
5061005	Stairway Support 1000	
5161001	Slabfix for Stairway	
5061103	Scaffoldfix for Stairway	

Needed Screws and Nuts

1. Screw M10 x 35 mm
2. Screw M10 x 40 mm
3. Screw M10 x 50 mm
4. Screw M10 x 60 mm
5. Screw M10 x 80 mm
6. Screw M10 x 120 mm

7. Nut M10
8. Nut M10 self-locking
9. Nut M10

10. Washer M10



User Manual : Stairway

Language : English



 **EasyStairs**
Tijdelijke toegangstrappen

Baron van Nagellstraat 80, 3781 AT Voorthuizen

T. 085 - 9020 265

info@easystairs.nl | www.easystairs.nl